

# IMPROVED ACCESS TO CUCKOO TRAIL - SECTION 1

**KEY**

- CARRIAGEWAY
- FOOTWAY
- GRASS VERGE
- EXISTING CUCKOO TRAIL
- DIRECTIONAL SIGN
- ON-ROAD CYCLE MARKING



PROPOSED DIRECTIONAL SIGN

PROPOSED DIRECTIONAL SIGN

PROPOSED DIRECTIONAL SIGN

IMPROVED ACCESS TO CUCKOO TRAIL FROM HAWKS ROAD

1

# IMPROVED ACCESS TO CUCKOO TRAIL - SECTION 2

**KEY**

- CARRIAGEWAY
- FOOTWAY
- GRASS VERGE
- EXISTING CUCKOO TRAIL
- DIRECTIONAL SIGN
- ON-ROAD CYCLE MARKING

PROPOSED ON-ROAD CYCLE ROUTE MARKINGS ON THE CEDARS FOR ROUTING CYCLISTS USING THE CUCKOO TRIAL

EXISTING CUCKOO TRAIL FOOTWAY

PROPOSED DIRECTIONAL SIGN

EXISTING DIRECTIONAL INFORMATORY SIGNS TO BE RETAINED

EXISTING CUCKOO TRAIL FOOTWAY

EXISTING CUCKOO TRAIL FOOTWAY

EXISTING CUCKOO TRAIL FOOTWAY

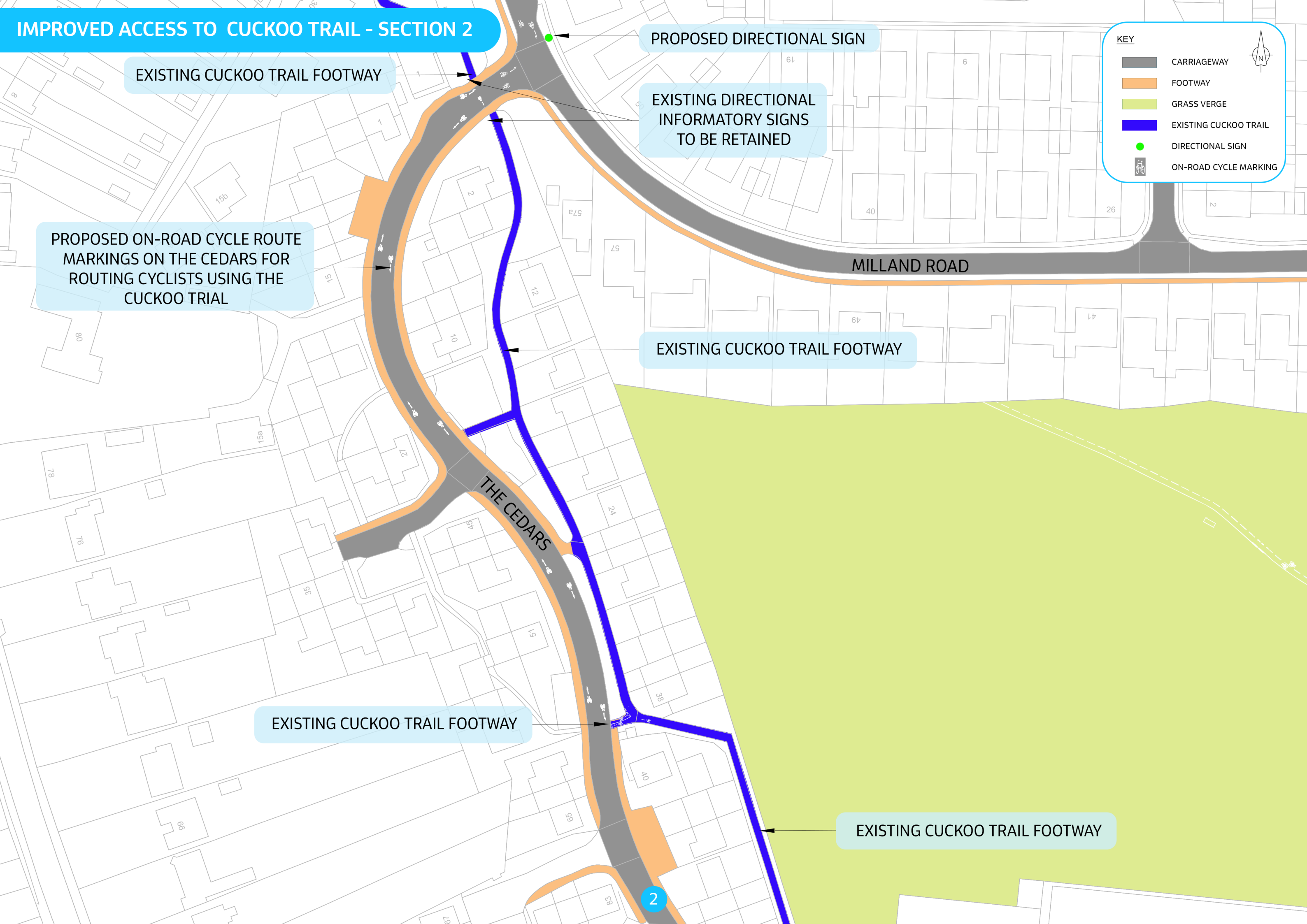

# IMPROVED ACCESS TO CUCKOO TRAIL - SECTION 3

**KEY**

- CARRIAGEWAY
- FOOTWAY
- SHARED USE FOOTWAY/CYCLEWAY
- GRASS VERGE
- EXISTING CUCKOO TRAIL
- ON-ROAD CYCLE MARKING
- PARALLEL CROSSING

EXISTING CUCKOO TRAIL

PROPOSED PATH OFF CUCKOO TRAIL PROVIDING ACCESS TO COMMUNITY COLLEGE

PROPOSED PARALLEL CROSSING ON A RAISED TABLE

EXISTING CUCKOO TRAIL

PROPOSED RAMPED PATH LINKING CUCKOO TRAIL TO LONDON ROAD

LONDON ROAD

3

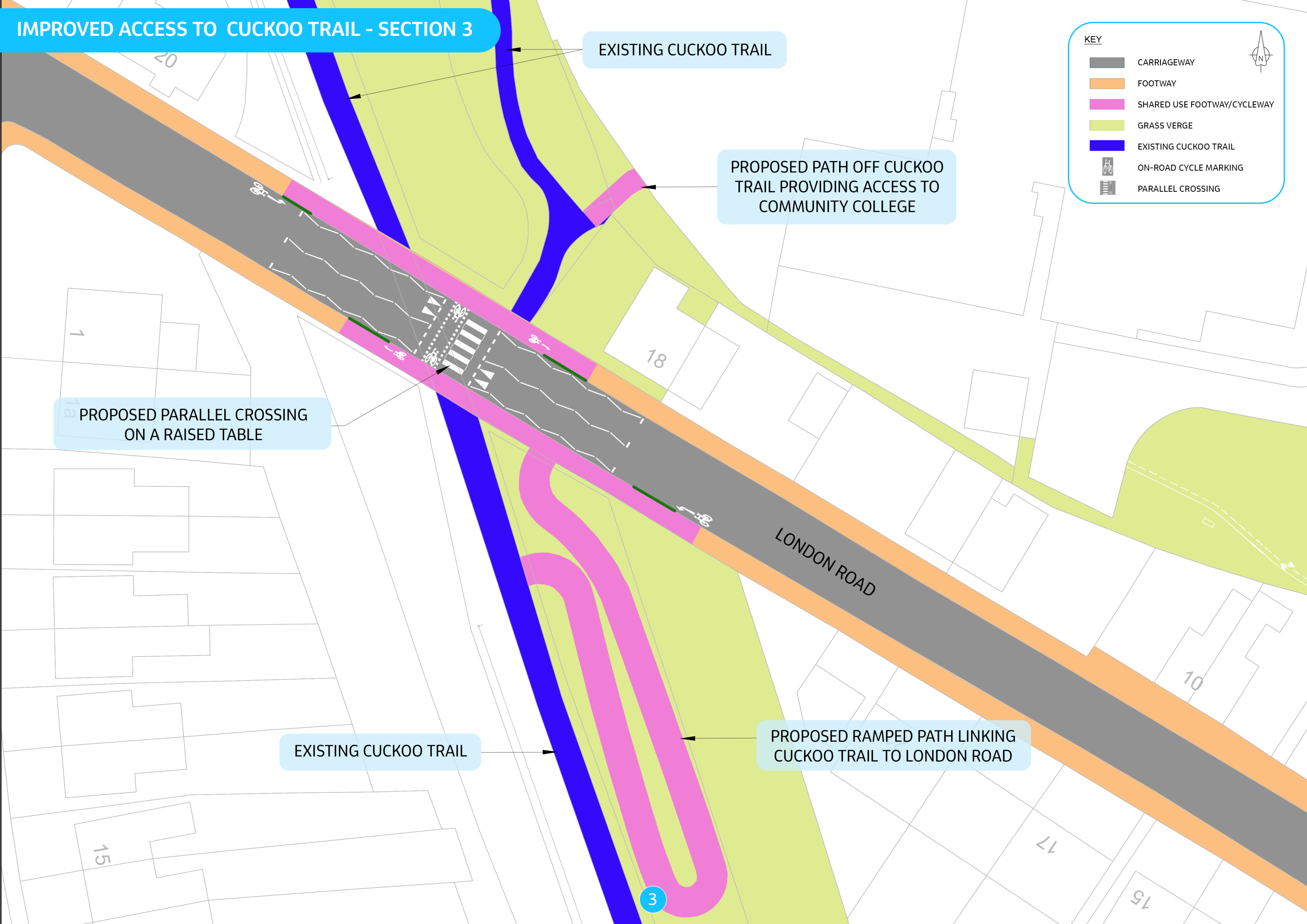

# IMPROVED ACCESS TO CUCKOO TRAIL - SECTION 4

**KEY**

- CARRIAGEWAY
- FOOTWAY
- GRASS VERGE
- EXISTING CUCKOO TRAIL

EXISTING CUCKOO TRAIL

EXISTING CUCKOO TRAIL

EXISTING CUCKOO TRAIL  
CONTINUES SOUTHWARDS  
TOWARDS POLEGATE

