

- Key to Restrictions**
- Existing 30mph Speed Limit
  - Proposed Reduction of 40mph Speed Limit
  - Existing 40mph Speed Limit

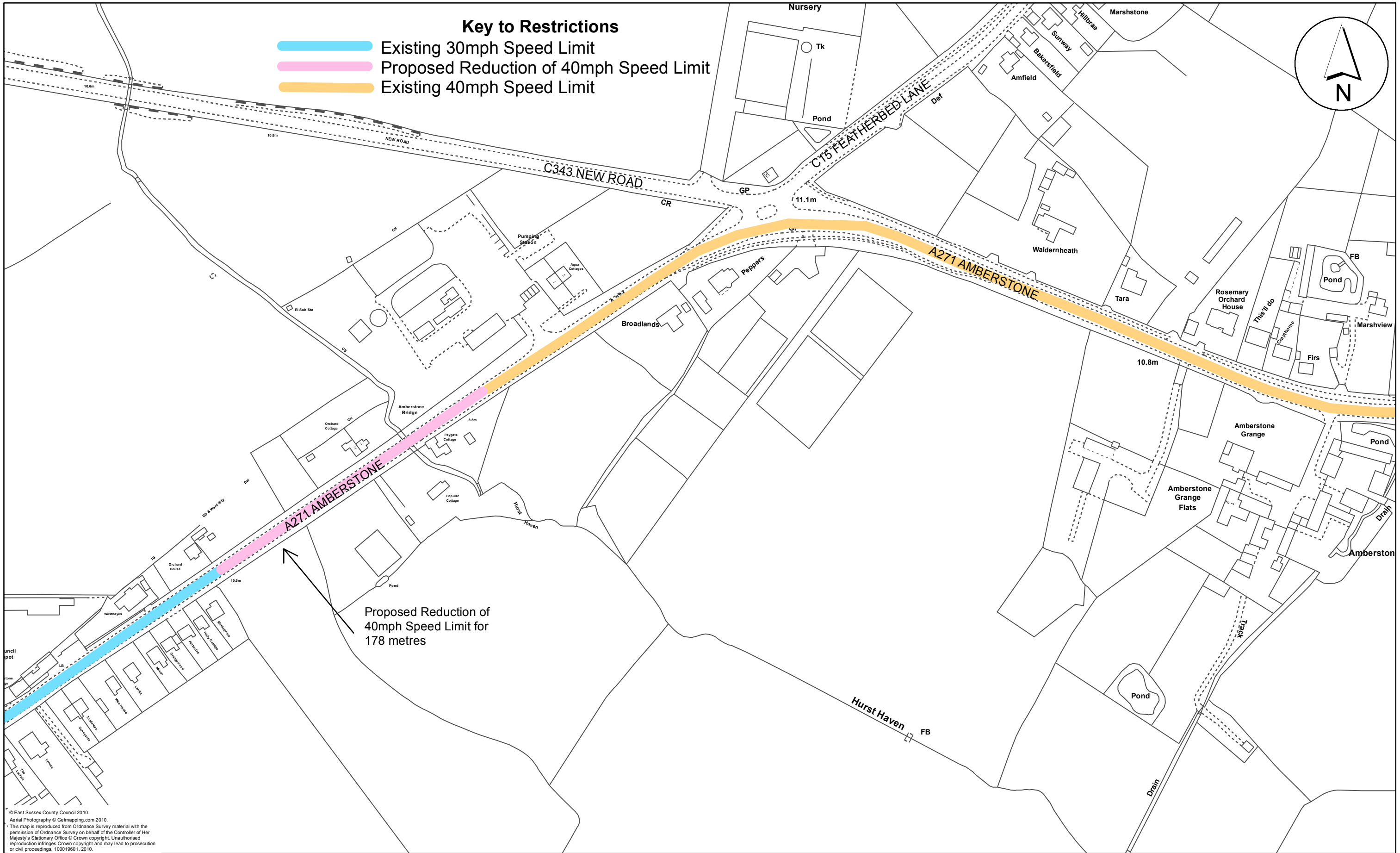
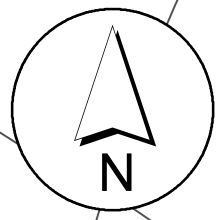

© East Sussex County Council 2010.  
 Aerial Photography © Getmapping.com 2010.  
 This map is reproduced from Ordnance Survey material with the permission of Ordnance Survey on behalf of the Controller of Her Majesty's Stationary Office © Crown copyright. Unauthorised reproduction infringes Crown copyright and may lead to prosecution or civil proceedings. 100019601, 2010.

**A271 - Amberstone. Proposed Reduction of 40mph Speed Limit**

Date: 17.05.2018

Scale: 1:2,000

East Sussex County Council  
 County Hall  
 St Annes Crescent  
 Lewes

Land tinted pink is considered to be adopted highway. The highway boundary, where researched, is shown in red outline. WHERE NO RED LINE IS SHOWN, THERE MAY BE MORE HIGHWAY THAN IS SHOWN IN PINK.