



## Phase 1 Marina and Marina Court Avenue pedestrian improvements

The following improvements would form part of Phase 1:

Widening of the footways on  
Marina and Marina Court Avenue

To encourage greater pedestrian movement  
between the seafront and the town centre  
by improving conditions for pedestrians

Relocating the existing zebra crossing,  
removing the central island and making  
the road narrower on either side

To encourage greater pedestrian movement  
between the seafront and the town centre  
by making it easier for pedestrians to cross the road

Removing the vehicular access to the  
De La Warr car park from  
Marina Court Avenue

To encourage greater pedestrian movement  
between the seafront and the town centre  
by reducing the number of vehicles using  
Marina Court Avenue

Introducing a new road  
surface on Marina Court Avenue

To reduce vehicle speeds and to make it  
easier for pedestrians to cross the road

Introducing a new parking layout  
on Marina Court Avenue and Marina

To enable the footways to be widened whilst  
retaining the on-street parking spaces

Introducing a coloured road surface  
on Channel View West

To encourage lower traffic speeds and inform  
drivers of the change in the character of  
the road

New and upgraded street lighting  
on Marina and Marina Court Avenue

To improve safety by ensuring that all  
road users are visible to one another

The estimated construction cost of introducing these  
measures is **£557,000**.

Please visit the Marina Court Garden  
section of this exhibition for  
more details.

Parking: there  
will be no overall  
change to the  
number of on-street  
parking spaces  
available.

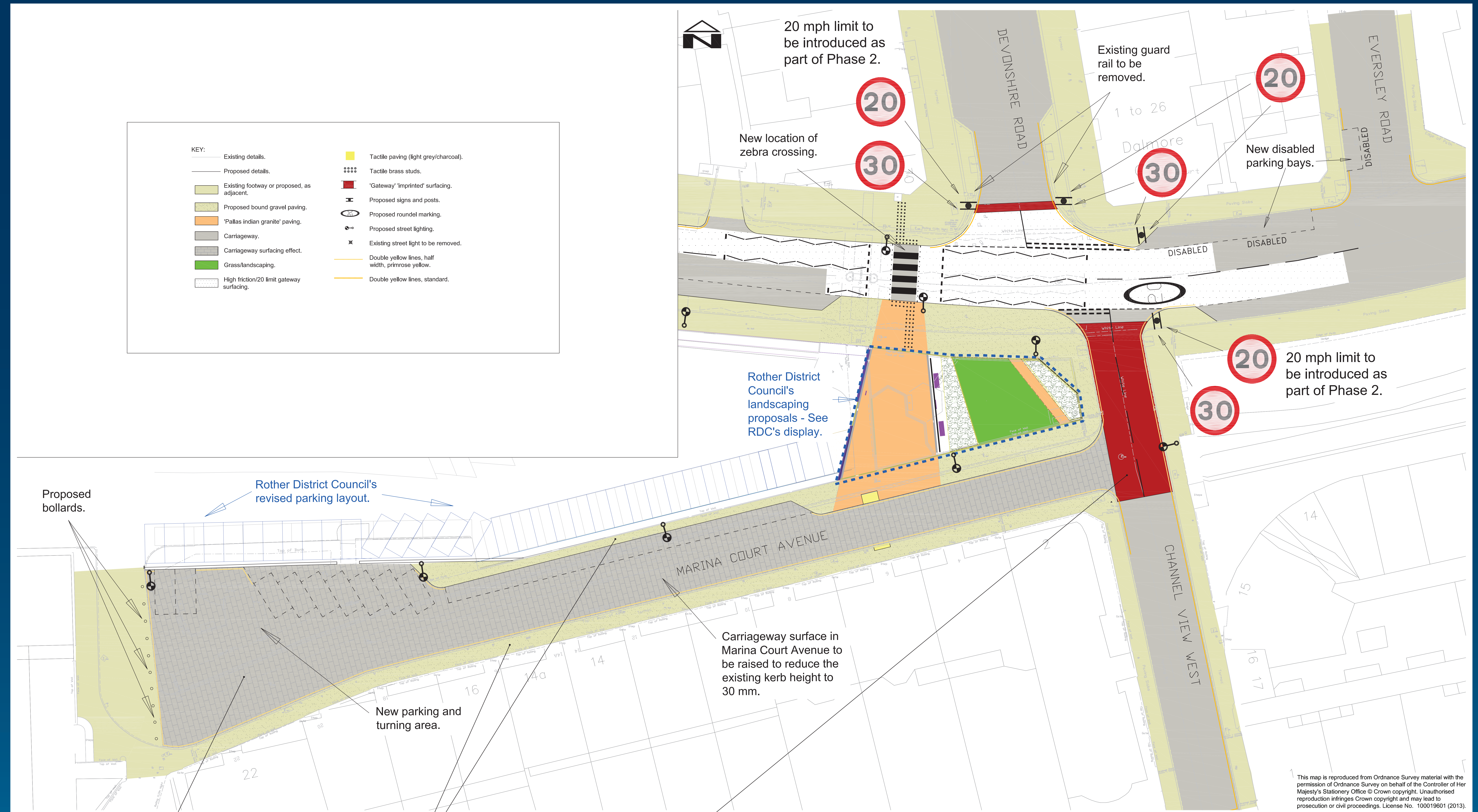

Example of carriageway  
surfacing effect.



Example of bound gravel  
surfacing – colour and type  
as landscaping area.



Example of a coloured  
road surface.