

- KEY**
- Proposed route for cyclists
 - Existing route for cyclists
 - Existing shared route for cyclists
 - Existing verge converted to shared cycle route
 - Existing footway route converted to shared cycle route
 - New raised road surface
 - Surface for removal
 - Proposed kerblines
 - Proposed White Road Markings
 - Sign post
 - Existing Lighting Column
 - Relocated Lighting Column
 - Existing Vegetation
 - Bollard
 - Buff Tactile Paving
 - Red Tactile Paving
 - Bus Shelter

LOCATION PLAN

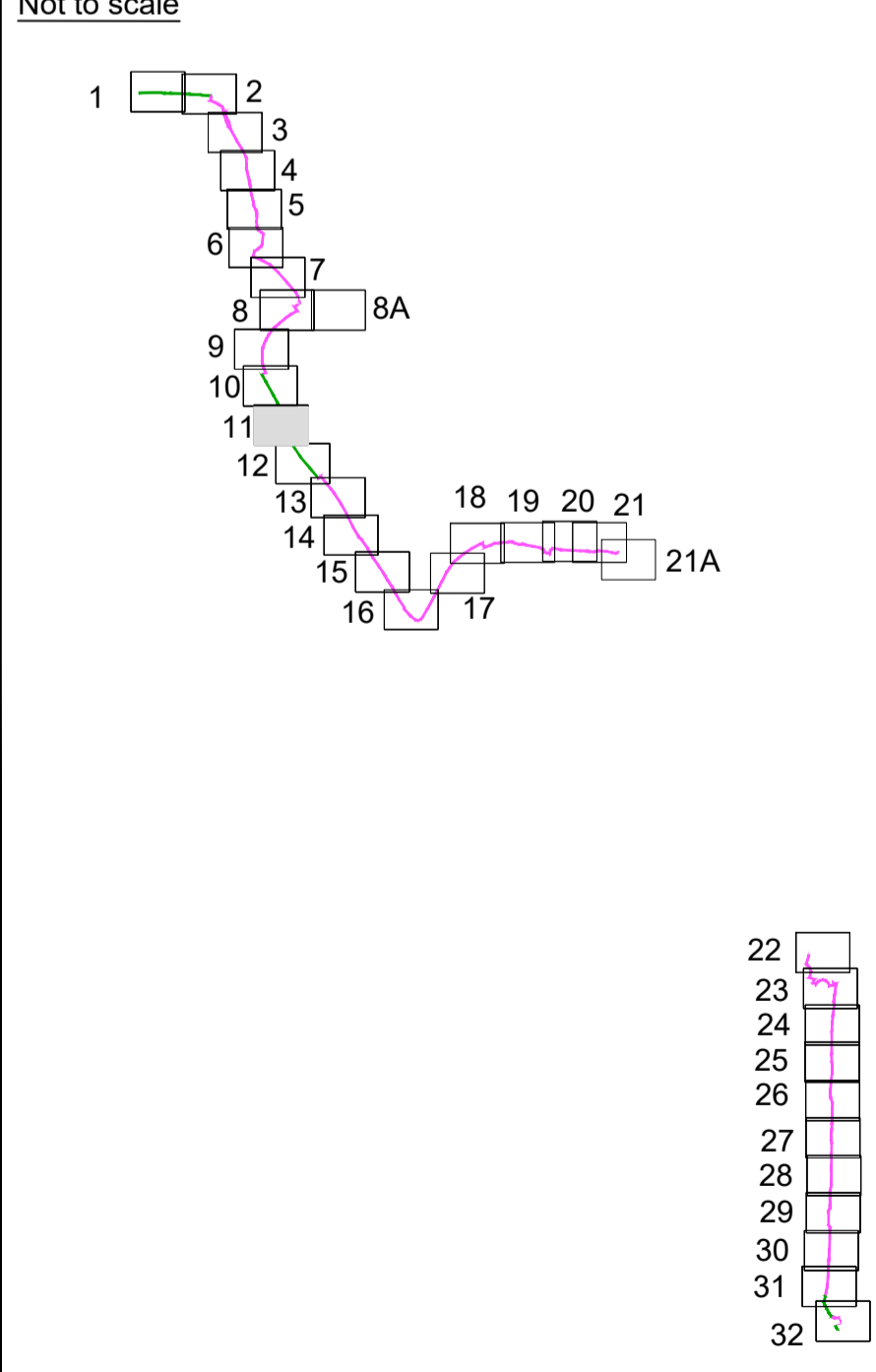

0 5 10 15 20
SCALE 1:250 (A1)
SCALE 1:500 (A3)
METRES

Rev	Status	Rev. Date	Purpose of revision	Drawn	Chk'd	Apprv'd
P01	09/12/2020	First Issue	STM	JG	JG	
P02	12/03/2021	Drawing Amendment	STM	JG	JG	

A partnership between:
COSTAIN CH2M

EAST SUSSEX HIGHWAYS
RINGMER DEPOT, THE BROYLE
RINGMER, EAST SUSSEX, BN8 5NP
Tel. 0345 60 80 193 www.eastsussexhighways.com

Project
STONE CROSS TO ROYAL PARADE CYCLE SCHEME

Drawing title
**Proposed Cycle Route
Consultation Plan**

11 of 32

Status	Revision
Scale	P02
Drawn By	Date
Checked By	09/12/2020
Approved By	
Project No.	Originator
3520000	ESH
Drawing number	Original Size
ENM-SCH0150-DR-2012	A1

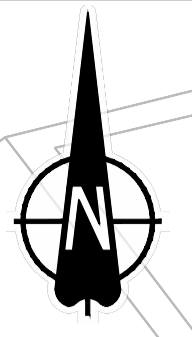
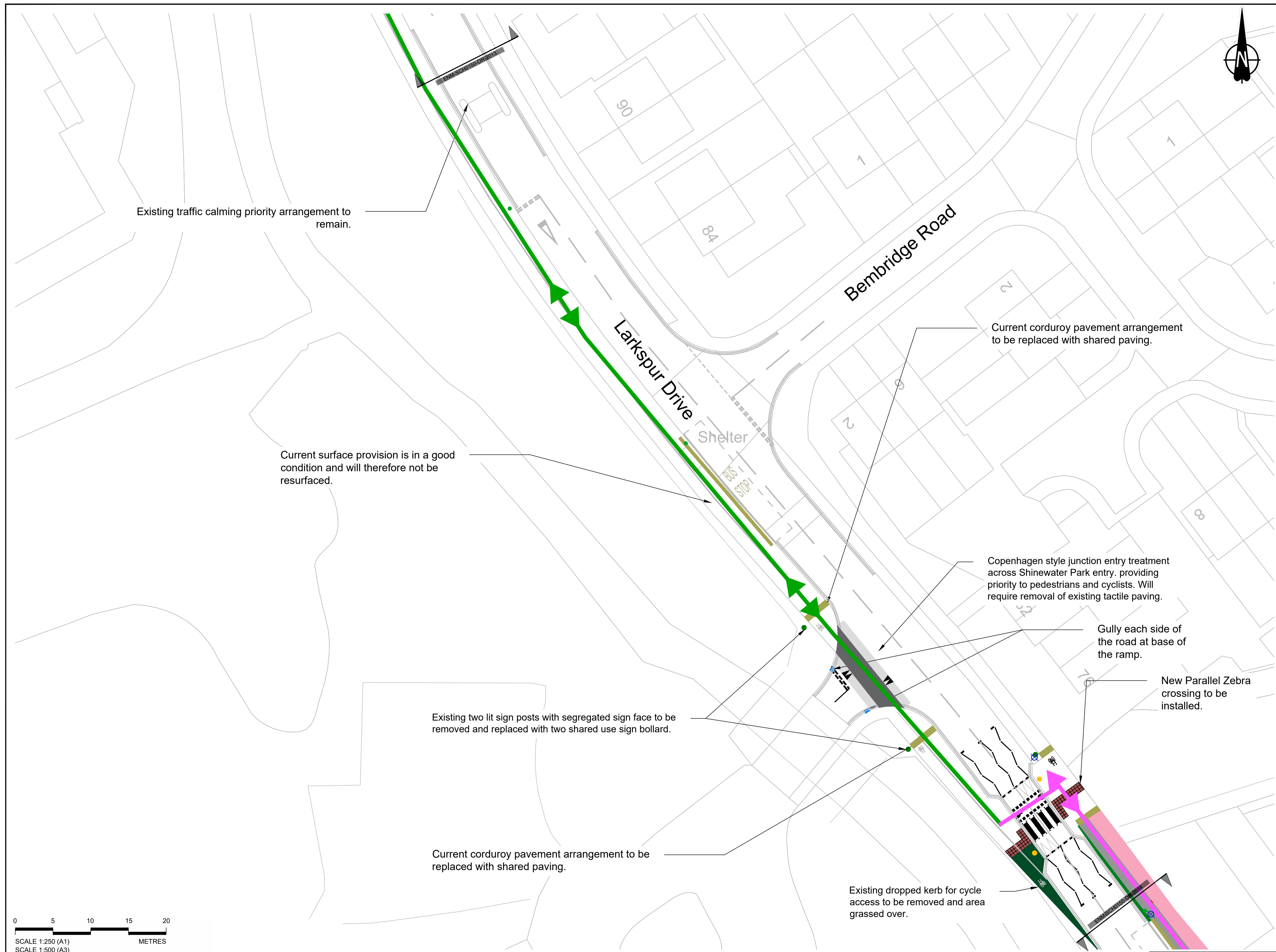

- KEY**
- Proposed route for cyclists
 - Existing route for cyclists
 - Existing shared route for cyclists
 - Existing verge converted to shared cycle route
 - Existing footway route converted to shared cycle route
 - New raised road surface
 - Surface for removal
 - Proposed kerblines
 - Proposed White Road Markings
 - Sign post
 - Existing Lighting Column
 - Relocated Lighting Column
 - Existing Vegetation
 - Bollard
 - Buff Tactile Paving
 - Red Tactile Paving
 - Bus Shelter

LOCATION PLAN

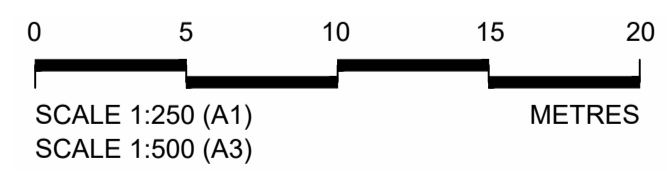
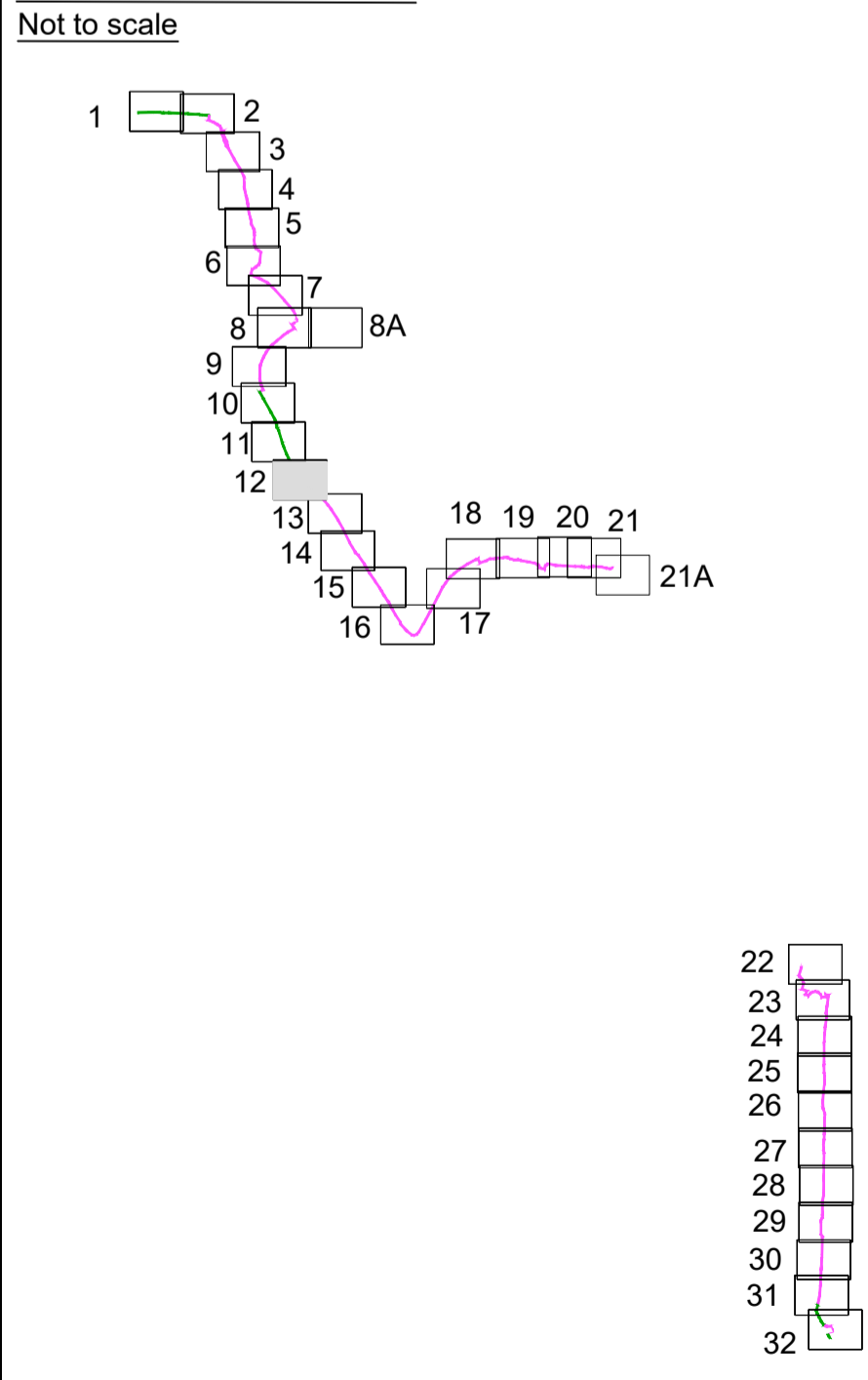

Rev	Status	Rev. Date	Purpose of revision	Drawn	Chk'd	Apprv'd
P01	09/12/2020	First Issue	STM	JG	JG	
P02	12/03/2021	Drawing Amendments	STM	JG	JG	

Project	STONE CROSS TO ROYAL PARADE CYCLE SCHEME
Drawing title	Proposed Cycle Route Consultation Plan 12 of 32

A partnership between:

EAST SUSSEX HIGHWAYS
 RINGMER DEPOT, THE BROYLE
 RINGMER, EAST SUSSEX, BN8 5NP
 Tel. 0345 60 80 193 www.eastsussexhighways.com

Status	P02
Scale	1:250@A1, 1:500@A3
Date	09/12/2020
Drawn By	STM
Checked By	JG
Approved By	JG
Project No.	3520000
Originator	ESH
Original Size	A1
Drawing number	ENM-SCH0150-DR-2013