

(A)

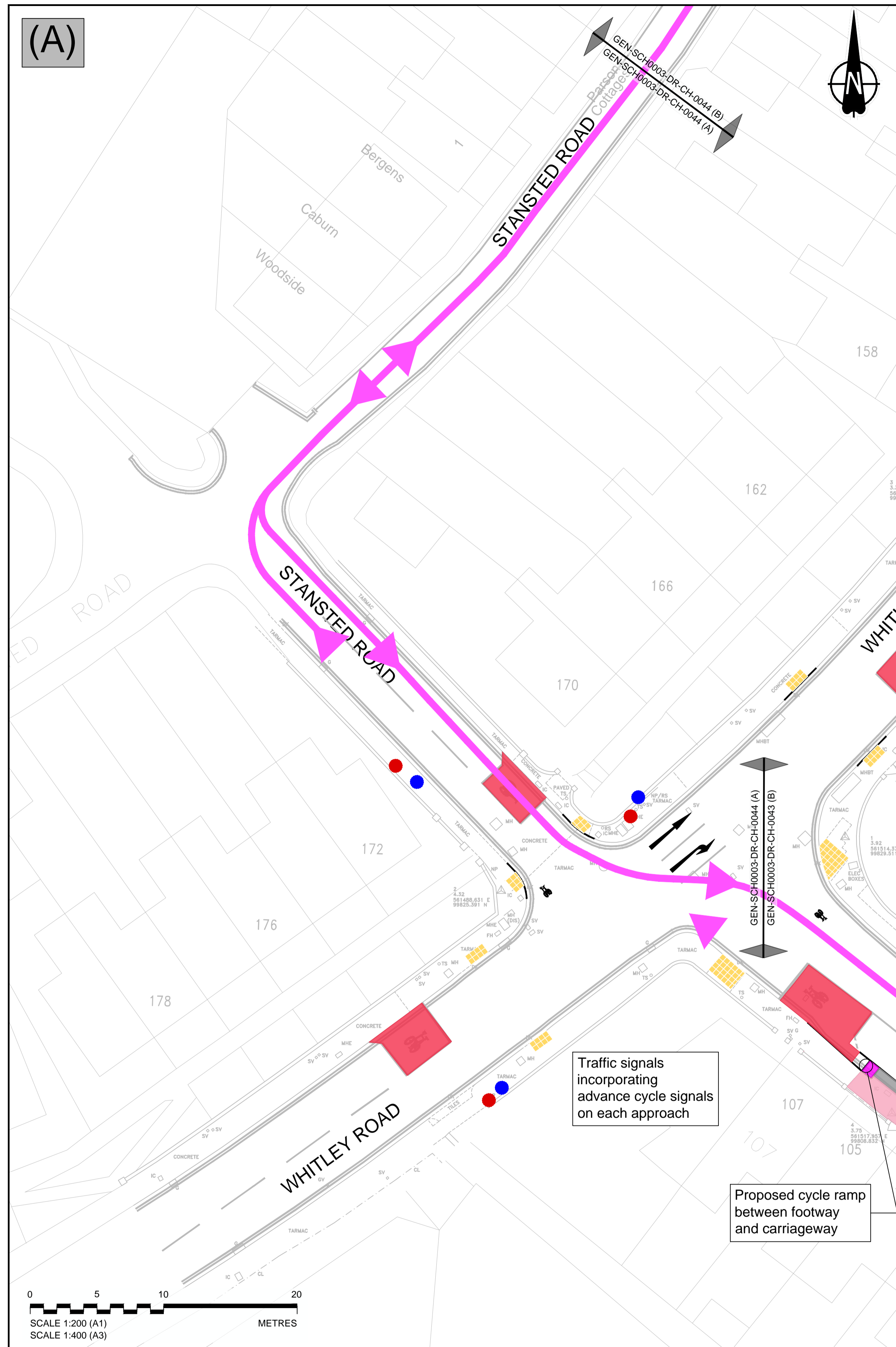

(B)

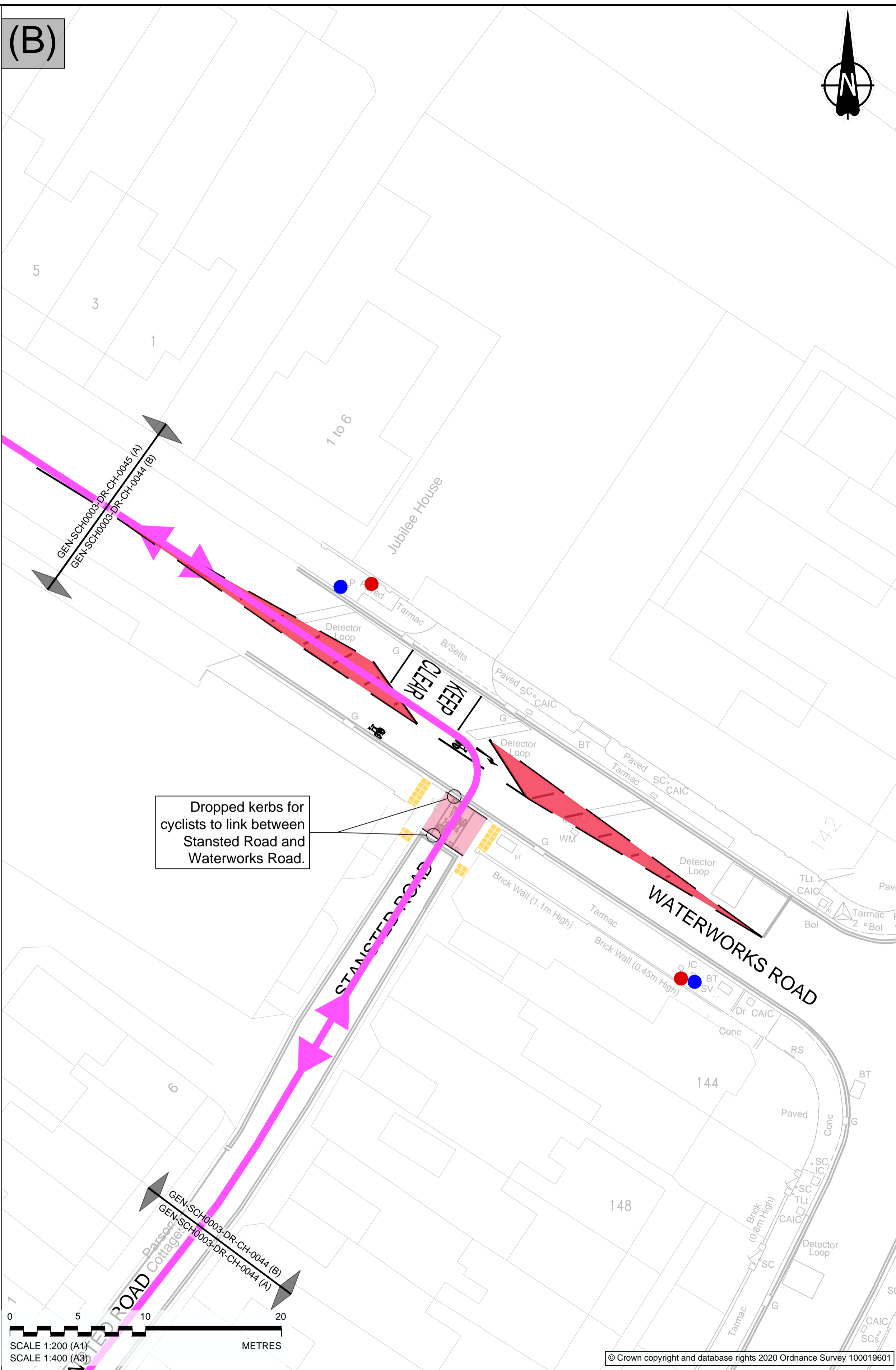

LEGEND:

- Proposed route for cyclists.
- Existing footway converted to shared cycle route.
- Proposed red coloured surfacing.
- Buff tactile paving.
- New / upgraded street lighting column.
- Street lighting column to be removed.

LOCATION PLAN

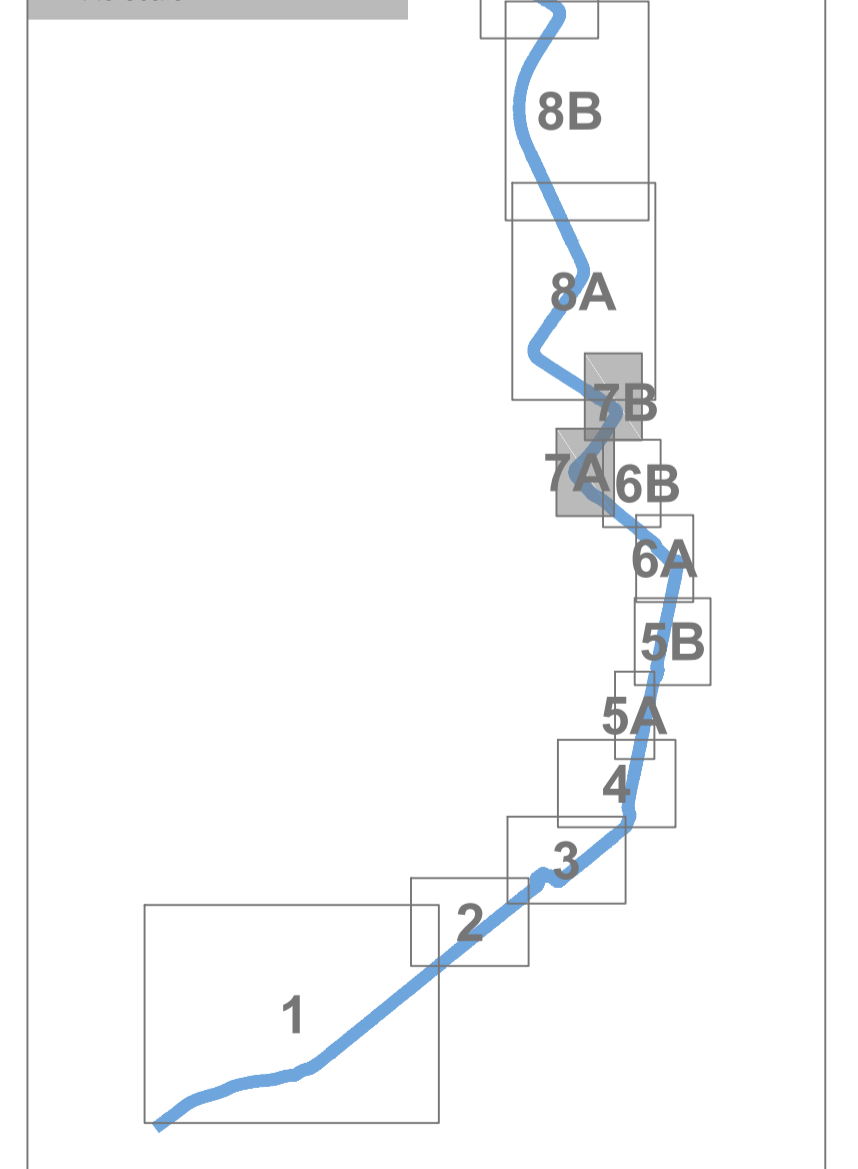

P06	S2	19/04/2021	Cycle slip relocated.	IT	CK	MR
P05	S2	30/11/2020	Colours updated	IT	CK	MR
P04	S2	18/05/2020	Final amends prior to consultation	IT	CK	MR
P03	S4	19/02/2020	House numbers & Street names added	IM	CK	MR
P02	S4	11/06/2019	For Construction	IM	CK	MR
P01	S4	20/05/2019	First issue	IM	CLS	MR
Rev	Status	Rev. Date	Purpose of revision	Drawn	Check'd	Apprv'd

East Sussex Highways
 A partnership between:

 EAST SUSSEX HIGHWAYS
 RINGMER DEPOT, THE BROYLE
 RINGMER, EAST SUSSEX, BN8 5NP
 Tel. 0345 60 80 193 www.eastsussexhighways.com

Project	SCH-003 HORSEY CYCLE ROUTE PHASE 1B
Drawing title	CONSULTATION DRAWING (Sheet 7 of 9)

Status	S2	Revision	P06
Scale	1:200	Date	20/05/2019
Drawn By	I Moreno		
Checked By	CLS		
Approved By	MR		
Project No.	3520000	Originator	ESH
Drawing number	GEN-SCH0003-DR-CH-0044	Original Size	A1