

**The East Sussex Lewes Town (Parking Places and Waiting and Loading
Restriction)Traffic Regulation Order 2014
Amendment No * 202***

Statement of Reasons

- In order to maintain access, to prevent obstruction and to maintain visibility at junctions, it is necessary to propose new or to make changes to existing No Waiting and No Waiting At Any Time and adjacent restrictions in these locations:
Firle Crescent, Highdown Road, Nevill Crescent and Valley Road.

- In order to increase parking provision for permit holders in zone C it is proposed to introduce new or make changes to existing Permit Holders Only bays and Permit Holder or Pay and Display bays in the following road:
South Street.

Further changes have been proposed which will ratify some of the provisions in the Traffic Regulation Order and which will have no physical change on site.

EAST SUSSEX COUNTY COUNCIL
ROAD TRAFFIC REGULATION ACT 1984

**The East Sussex Lewes Town (Parking Places and Waiting and Loading
Restriction)Traffic Regulation Order 2014
Amendment No * 202***

Notice is hereby given that East Sussex County Council propose to make the above Order under the relevant sections of the Road Traffic Regulation Act 1984, as amended, along with all other enabling powers which will introduce new or revise the existing parking, waiting and loading restrictions along the following lengths of roads:-

Changes to **Prohibition of Waiting At Any Time** in the following roads:
Firle Crescent, Highdown Road, Nevill Crescent and Valley Road.

Changes to **Prohibition of Waiting, 8am-6pm Monday to Friday** in the following road:
Valley Road.

Changes to **Permit Holder or Pay and Display Parking Places, Monday to Saturday, 9am-5pm** in the following road:
South Street.

Changes to **Permit Holder Only Parking Places, Monday to Saturday, 9am-5pm** in the following road:
South Street.

A copy of the draft Order, plans and a statement of the Council's reasons for proposing the Order can be viewed at consultation.eastsussex.gov.uk/economy-transport-environment/lewes-formal-2020. Due to current social distancing requirements, paper copies of documents will not be available to view in our council offices or libraries. People without access to a computer who wish to view details of the scheme should telephone the Parking Team on 01323 466244 to receive the documents by post.

Any person wishing to make an objection or other representation concerning this proposal must do so in writing, together with the grounds on which it is made, to Parking, East Sussex County Council, County Hall, St Anne's Crescent, Lewes, East Sussex, BN7 1UE, or by email to parking.escc@eastsussex.gov.uk or online at consultation.eastsussex.gov.uk/economy-transport-environment/lewes-formal-2020 by 26 March 2021 quoting ref TRO/448.

If you require further information telephone Parking Services on 01323 466244.

Phillip Baker, Assistant Chief Executive
Governance Services Department, County Hall, Lewes, East Sussex, BN7 1UE

5 March 2021

EAST SUSSEX COUNTY COUNCIL

ROAD TRAFFIC REGULATION ACT 1984, ROAD TRAFFIC ACT 1991 & TRAFFIC MANAGEMENT ACT 2004

The East Sussex Lewes Town (Parking Places and Waiting and Loading Restrictions) Traffic Regulation Order 2014 Amendment No * Order 202*

East Sussex County Council, in exercise of their powers under Sections 1(1), 2(1) to (4), 3(2), 4(2), 32, 35(1) and (3), 45, 49, 51, 52, 53 of, and Part IV of Schedule 9 to the Road Traffic Regulation Act 1984 ("the Act") as amended, the Road Traffic Act 1991 (as amended), Part 6 of the Traffic Management Act 2004, and of all other enabling powers and after consultation with the Chief Officer of Police in accordance with Part III of Schedule 9 to the Act hereby make the following Order:-

1. Commencement and citation

This Order may be cited as "The East Sussex Lewes Town (Parking Places and Waiting and Loading Restrictions) Traffic Regulation Order 2014 Amendment No.* Order 202*" and shall come into effect on xxx xxx xxx

2. When this Order comes into effect:

(a) The East Sussex Lewes Town (Parking Places and Waiting and Loading Restrictions) Traffic Regulation Order 2014, as amended, shall have effect except as hereinafter contained.

(i) In article 1 Interpretation delete the definition of resident and replace with the following definition:

"resident" for the purpose of this Order means a person whose usual place of abode is at premises the postal address of which is in any street or property within the boundaries of the zones shown on the Lewes Permit Zones map of the Order Plans, provided that the street is not private;

(ii) The Order Plans shall be amended as follows:

The map tiles below shall be revoked	The map tiles below shall be inserted
	Overview Revision *
LH102	LH102 Revision 1
LK103 Revision 1	LK103 Revision 2
LN110	LN110 Revision 1
LP103	LP103 Revision 1

3. Revocations

The following Orders and associated Amendment Orders are hereby revoked in their entirety:

Lewes (Various Roads, Lewes) (Prohibition and Restriction of Waiting and Disabled Persons Parking Places) Order 1989
The East Sussex (Lewes Town Centre) (Parking Places) Experimental Traffic Order 2006
The East Sussex (Lewes Town Centre) (Waiting and Loading Restriction) Experimental Traffic Order 2006
The East Sussex (Lewes Town Centre Extension) (Parking Places) Experimental Traffic Order 2006
The East Sussex (Lewes Town Centre Extension) (Waiting and Loading Restriction) Experimental Traffic Order 2006
The East Sussex (Lewes Town Centre Extension) (Parking Places) Traffic Regulation Order 2007 Amendment No.1 2014
The East Sussex (Lewes Town Centre Extension) (Waiting and Loading Rest) Traffic Regulation Order 2007 Amendment 2013 No.1
The East Sussex (Lewes Town Centre) (Waiting and Loading Restriction) Traffic Regulation Order 2007 Amendment 2008 No.1
The East Sussex (Lewes Town Centre) (Waiting and Loading Restriction) Traffic Regulation Order 2007 Amendment 2013 No.1
The East Sussex (Lewes Town Centre Extension) (Parking Places) Traffic Regulation Order 2007 Amendment Order 2015 No.1
The East Sussex (Lewes Town Centre Extension) (Waiting And Loading Restrictions) Traffic Regulation Order 2007 Amendment Order 2015 No.1
The East Sussex (Lewes Town Centre Extension) (Parking Places) Traffic Regulation Order 2007 Amendment Order 2013 No.1
The East Sussex (Lewes Town Centre) (Parking Places) Traffic Regulation Order 2007 Amendment Order 2012 No.2
The East Sussex (Lewes Town Centre) (Parking Places) Traffic Regulation Order 2007 Amendment Order 2013 No.1
The East Sussex (Lewes Town Centre) (Parking Places) Traffic Regulation Order 2007 Amendment Order No.1 2014
The East Sussex (Lewes Town Centre) (Parking Places) Traffic Regulation Order 2007 Amendment Order 2008 No.1
The East Sussex (Lewes Town Centre)(Parking Places) Traffic Regulation Order 2007
The East Sussex(Lewes Town Centre)(Waiting and Loading Restriction) Traffic Regulation Order 2007

THE COMMON SEAL of EAST SUSSEX)
COUNTY COUNCIL was affixed)
hereto on the day of two)
thousand and in the presence of:-)

Authorised Signatory

H & T Ctte. 2.4.74 - para 4.2 joint report of Director of Legal
& Community Services & County Engineer - para 4.

**The East Sussex Lewes Town (Parking Places and Waiting and Loading Restriction)
Traffic Regulation Order 2014 Amendment No * Order 202***

The Order Plans

Amendments

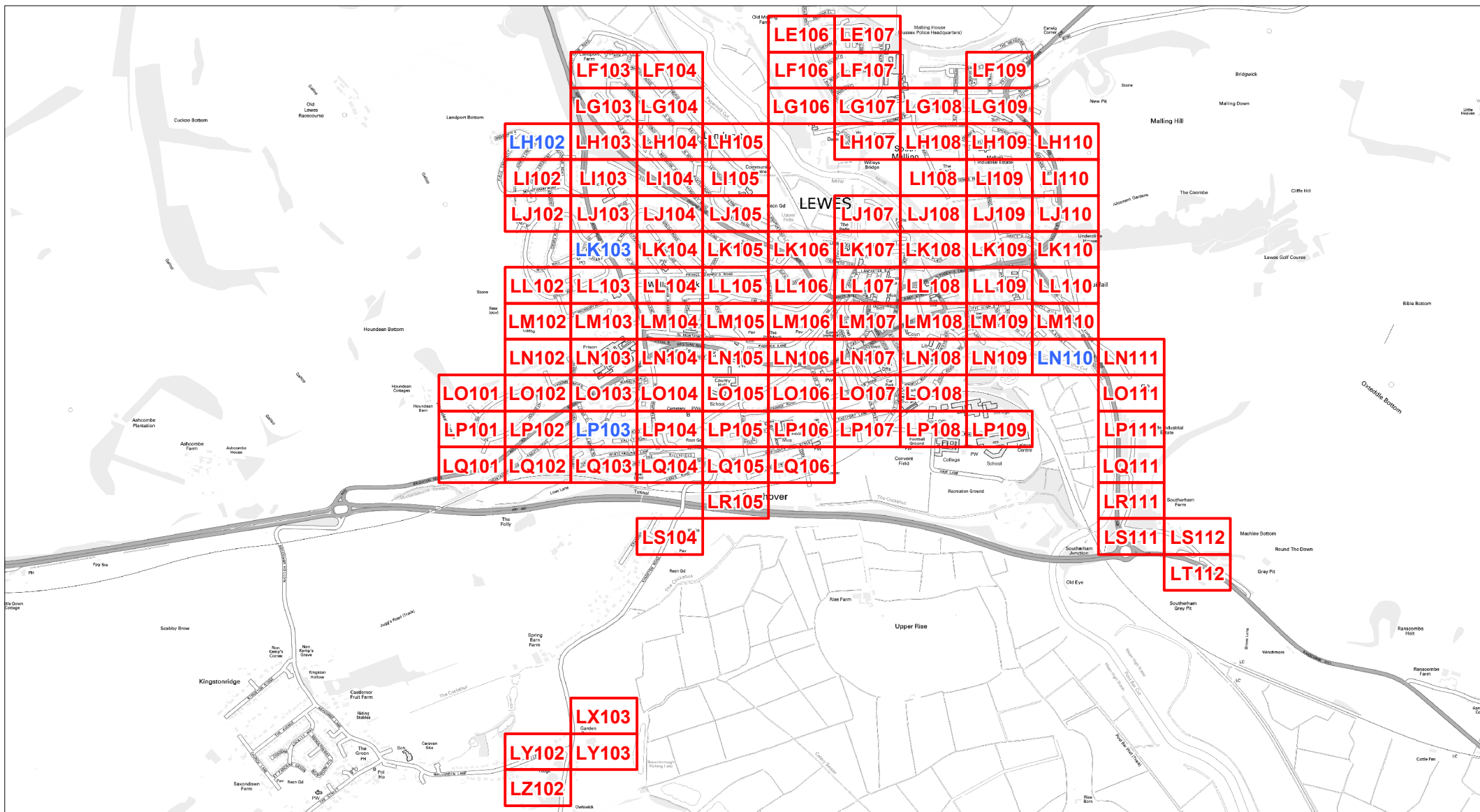

The East Sussex Lewes Town
(Parking Places and Waiting
and Loading Restrictions)
Traffic Regulation Order 2014
Amendment Order No * 202*

Locations of Parking and Waiting Restrictions

- LR000 Existing Tile
- LR000 Revised Tile

© Crown copyright. All rights reserved
East Sussex County Council
Licence No. 100019601 2021



SCALE 1:22,500

DATE 10/02/2021

Tile Ref: Overview Revision: 7

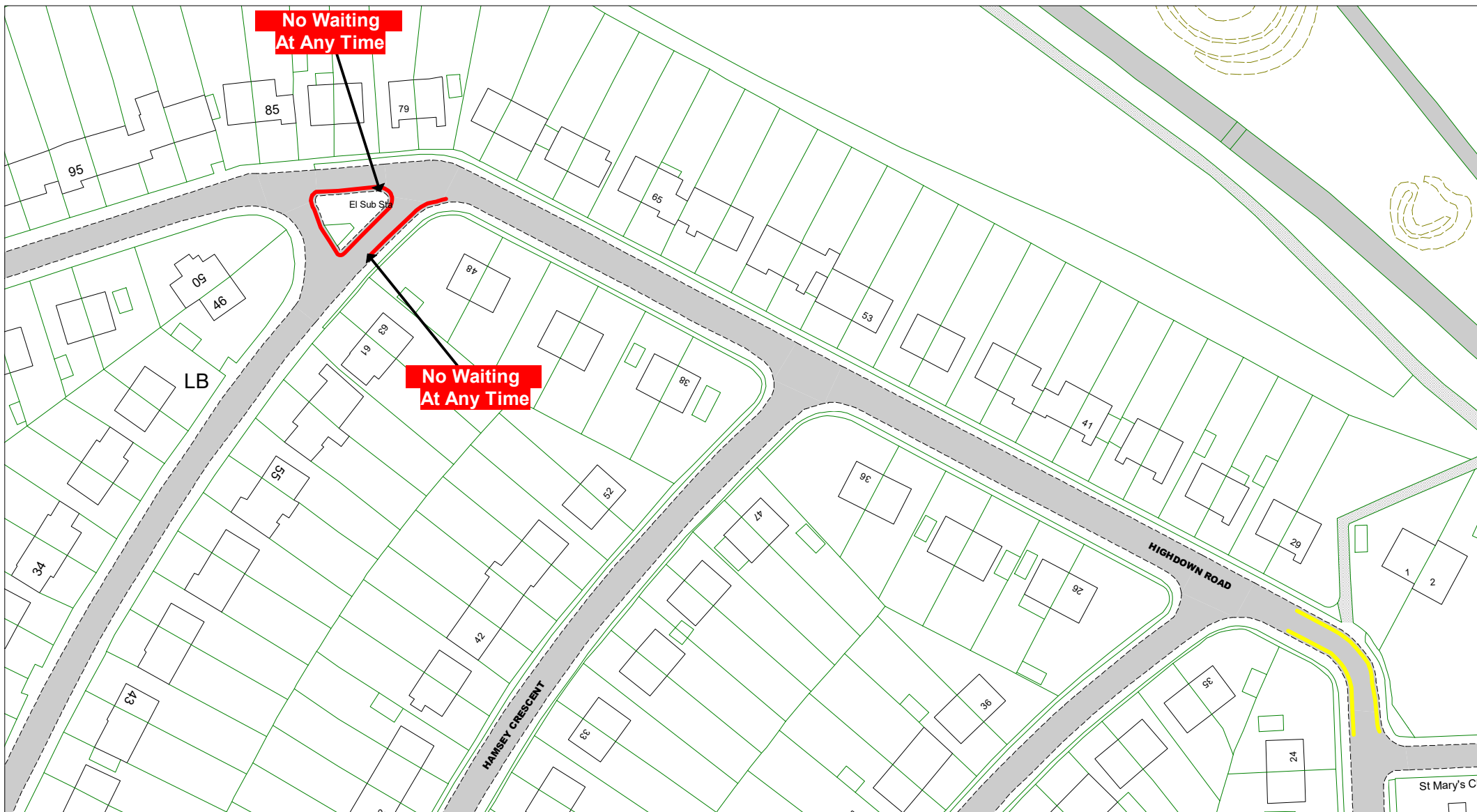

© Crown copyright. All rights reserved
 East Sussex County Council
 Licence No. 100019601 2021



The East Sussex Lewes Town
 (Parking Places and Waiting and
 Loading Restrictions) Traffic
 Regulation Order 2014 Amendment
 Order No.* 202*

Key to Non TRO Items

- Pedestrian Crossing (controlled area)
- Pedestrian Crossing Point
- Bus Stop/ Stand Clearway

Key to TRO Restriction Types

- No Waiting at Any Time
- No Waiting
- No Loading at Any Time
- No Loading at Any Time Pay and Display
- Permit Holders Only
- Permit Holders or Pay and Display
- Permit Holders or Time Limited Limited Waiting
- Disabled Badge Holders Only

- Taxi Only
- Motorcycles Only
- Loading/ Unloading Only
- Car Club Permit Only
- No Stopping on Footway or Verge
- No Waiting Vehicles over 5 tonnes gross weight
- No Stopping On Entrance Markings
- Restricted Parking Zone No Waiting at Any Time

Key to Labels

- Proposed New or Change to Existing Permanent TRO restriction
- Proposed Permanent TRO restriction
- Non TRO item
- Proposed No Waiting At Any Time
- Proposed removal of No Waiting At Any Time

Adjacent Map Tile

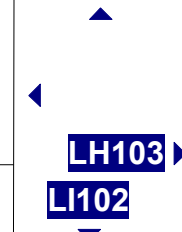

SCALE	1 : 1000
DATE	23/02/2021

Tile Ref: LH102
 Revision: 1

PROPOSED

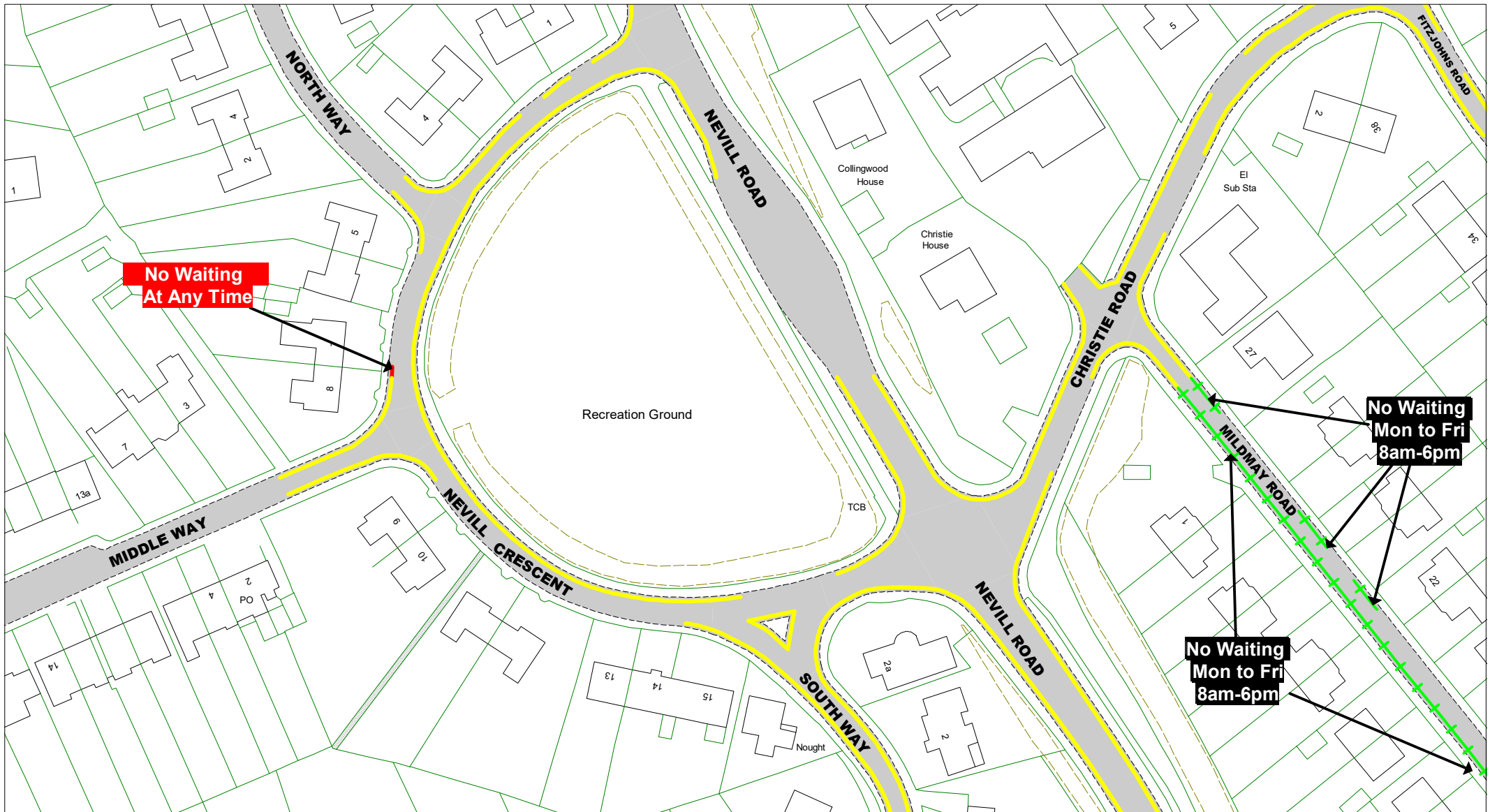

© Crown copyright. All rights reserved
 East Sussex County Council
 Licence No. 100019601 2021



The East Sussex Lewes Town
 (Parking Places and Waiting and
 Loading Restrictions) Traffic
 Regulation Order 2014 Amendment
 Order No.* 202*

Key to Non TRO Items

- Pedestrian Crossing (controlled area)
- Pedestrian Crossing Point
- Bus Stop/Stand Clearway

Key to TRO Restriction Types

- No Waiting at Any Time
- No Waiting
- No Loading at Any Time
- No Loading at Any Time Pay and Display
- Permit Holders Only
- Permit Holders or Pay and Display
- Permit Holders or Time Limited
- Limited Waiting
- Disabled Badge Holders Only

- Taxi Only
- Motorcycles Only
- Loading/ Unloading Only
- Car Club Permit Only
- No Stopping on Footway or Verge
- No Waiting Vehicles over 5 tonnes gross weight
- No Stopping On Entrance Markings
- Restricted Parking Zone No Waiting at Any Time

Key to Labels

- Proposed New or Change to Existing Permanent TRO restriction
- Proposed Permanent TRO restriction
- Non TRO item
- Proposed No Waiting At Any Time
- Proposed removal of No Waiting At Any Time

Adjacent Map Tile

LJ103

LK104

LL103



SCALE 1 : 1000
 DATE 23/02/2021

Tile Ref: LK103
 Revision: 2

PROPOSED

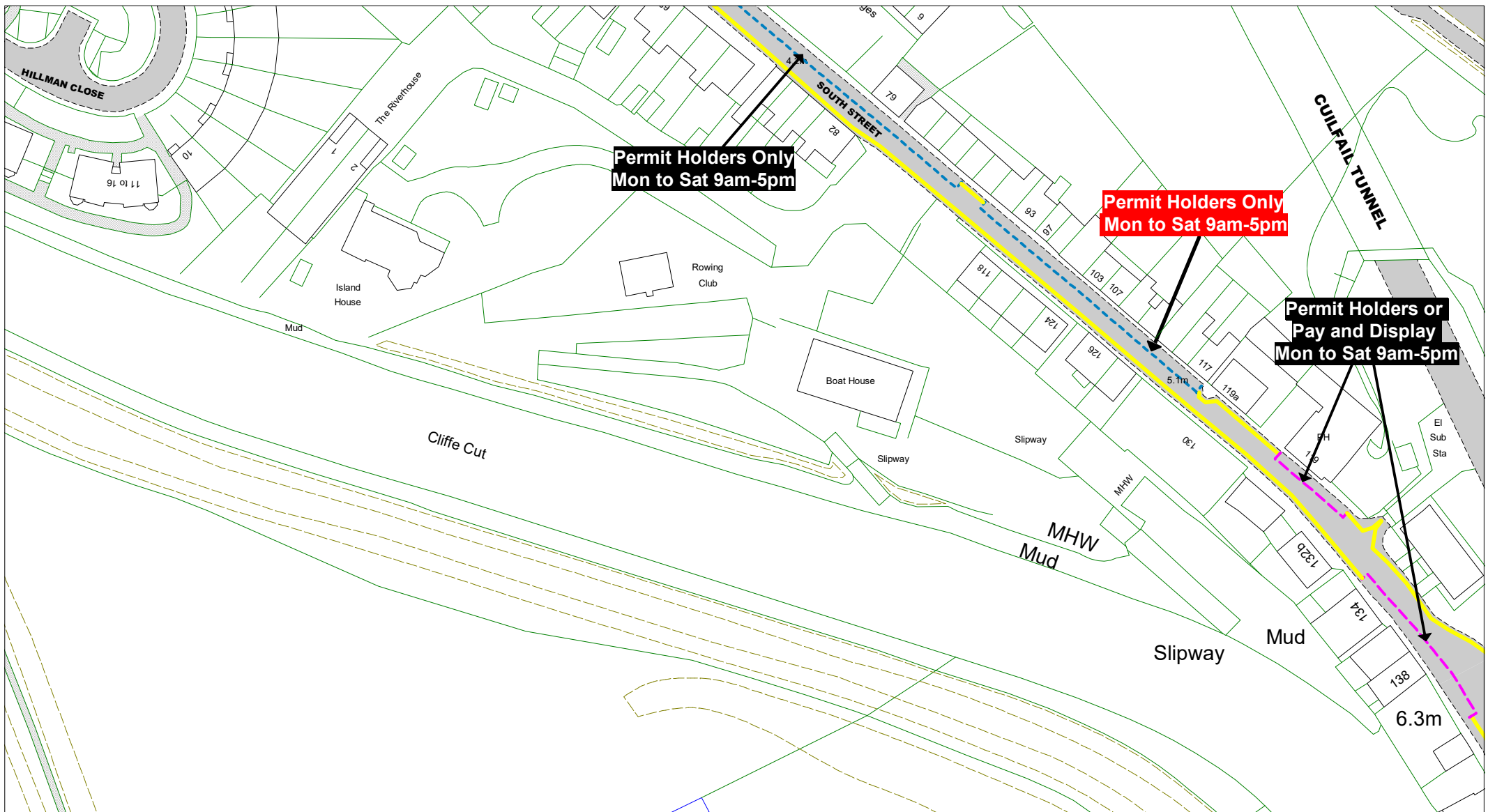

© Crown copyright. All rights reserved
 East Sussex County Council
 Licence No. 100019601 2021



The East Sussex Lewes Town
 (Parking Places and Waiting and
 Loading Restrictions) Traffic
 Regulation Order 2014 Amendment
 Order No.* 202*

- Key to Non TRO Items**
- Pedestrian Crossing (controlled area)
 - Pedestrian Crossing Point
 - Bus Stop/Stand Clearway

Key to TRO Restriction Types

- No Waiting at Any Time
- No Waiting
- No Loading at Any Time
- No Loading at Any Time Pay and Display
- Permit Holders Only
- Permit Holders or Pay and Display
- Permit Holders or Time Limited
- Limited Waiting
- Disabled Badge Holders Only

- Taxi Only
- Motorcycles Only
- Loading/ Unloading Only
- Car Club Permit Only
- No Stopping on Footway or Verge
- No Waiting Vehicles over 5 tonnes gross weight
- No Stopping On Entrance Markings
- Restricted Parking Zone No Waiting at Any Time

- Key to Labels**
- Proposed New or Change to Existing Permanent TRO restriction
 - Proposed Permanent TRO restriction
 - Non TRO item
 - Proposed No Waiting At Any Time
 - Proposed removal of No Waiting At Any Time

Adjacent Map Tile

▲

 ▲

 ▲

 ▼

N
 W — O — E
 S

SCALE	1 : 1000
DATE	23/02/2021
Tile Ref: LN110 Revision: 1	

PROPOSED

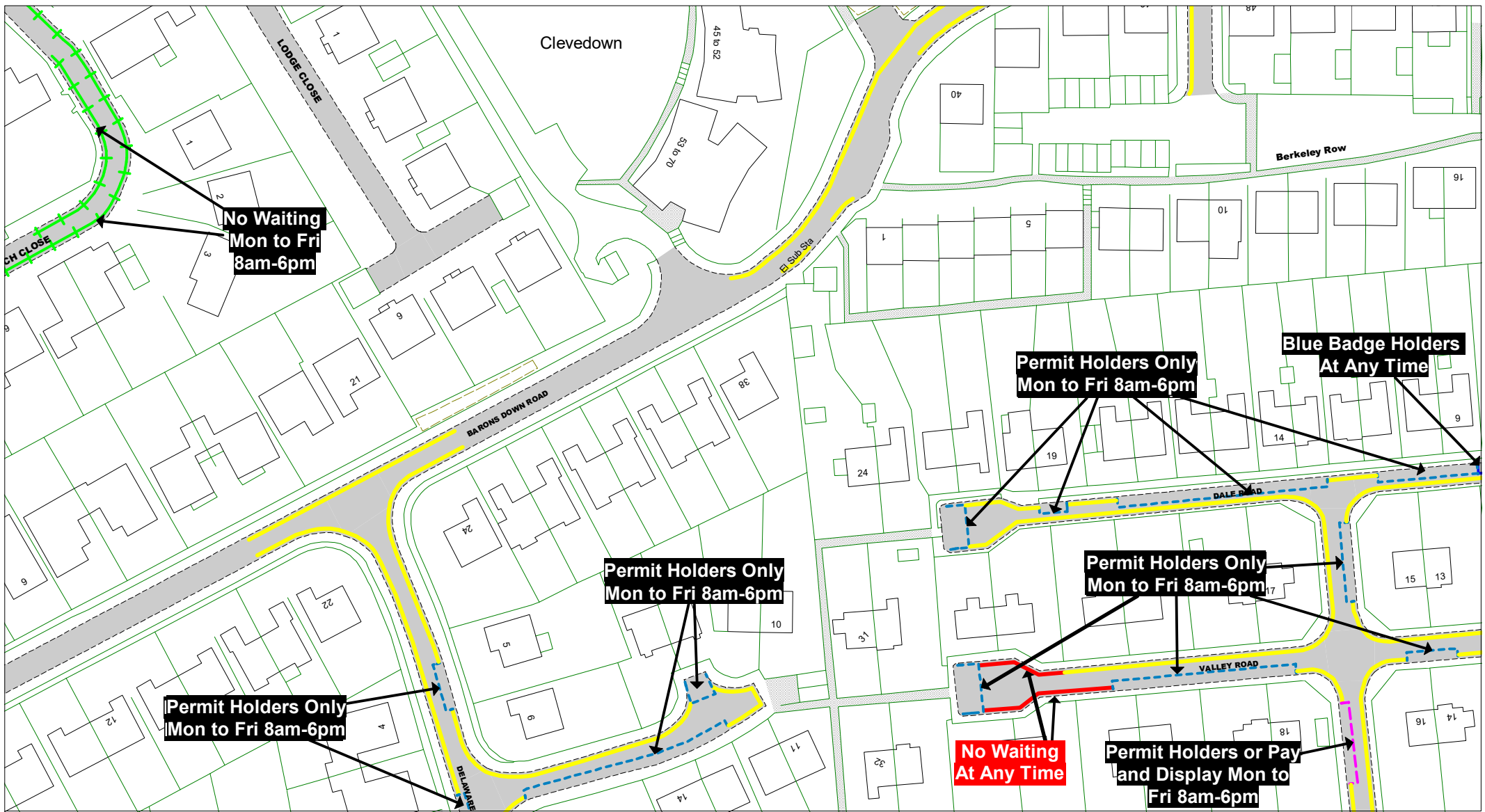

© Crown copyright. All rights reserved
 East Sussex County Council
 Licence No. 100019601 2021



The East Sussex Lewes Town
 (Parking Places and Waiting and
 Loading Restrictions) Traffic
 Regulation Order 2014 Amendment
 Order No.* 202*

Key to Non TRO Items

	Pedestrian Crossing (controlled area)
	Pedestrian Crossing Point
	Bus Stop/Stand Clearway

Key to TRO Restriction Types

	No Waiting at Any Time
	No Waiting
	No Loading at Any Time
	No Loading at Any Time Pay and Display
	Permit Holders Only
	Permit Holders or Pay and Display
	Permit Holders Only
	Permit Holders or Time Limited
	Limited Waiting
	Disabled Badge Holders Only

	Taxi Only
	Motorcycles Only
	Loading/Unloading Only
	Car Club Permit Only
	No Stopping on Footway or Verge
	No Waiting Vehicles over 5 tonnes gross weight
	No Stopping on Entrance Markings
	Restricted Parking Zone No Waiting at Any Time

Key to Labels

	Proposed New or Change to Existing Permanent TRO restriction
	Proposed Permanent TRO restriction
	Non TRO item
	Proposed No Waiting at Any Time
	Proposed removal of No Waiting at Any Time

Adjacent Map Tile

▲	LO103
◀	LP102
	LP104 ▶
▼	LQ103

SCALE	1 : 1000
DATE	23/02/2021
Tile Ref: LP103 Revision: 1	

PROPOSED