

## EAST SUSSEX COUNTY COUNCIL

### ROAD TRAFFIC REGULATION ACT 1984, ROAD TRAFFIC ACT 1991 & TRAFFIC MANAGEMENT ACT 2004

#### The East Sussex Lewes Town (Parking Places and Waiting and Loading Restrictions) Traffic Regulation Order 2014 Amendment No 2 Order 2023

East Sussex County Council, in exercise of their powers under Sections 1(1), 2(1) to (4), 3(2), 4(2), 32, 35(1) and (3), 45, 49, 51, 52, 53 of, and Part IV of Schedule 9 to the Road Traffic Regulation Act 1984 ("the Act") as amended, the Road Traffic Act 1991 (as amended), Part 6 of the Traffic Management Act 2004, and of all other enabling powers and after consultation with the Chief Officer of Police in accordance with Part III of Schedule 9 to the Act hereby make the following Order:-

#### 1. Commencement and citation

This Order may be cited as "The East Sussex Lewes Town (Parking Places and Waiting and Loading Restrictions) Traffic Regulation Order 2014 Amendment No.\* Order 202\*" and shall come into effect on 12 June 2023

#### 2. When this Order comes into effect:

(a) The East Sussex Lewes Town (Parking Places and Waiting and Loading Restrictions) Traffic Regulation Order 2014, as amended, shall have effect except as hereinafter contained.

(i) The Order Plans shall be amended as follows:

The map tiles below shall be revoked	The map tiles below shall be inserted
	Overview Revision 2023
LI104	LI104 Revision 2023
LI105	LI105 Revision 2023
LJ104	LJ104 Revision 2023
LJ105	LJ105 Revision 2023
LM109	LM109 Revision 2023
LO107	LO107 Revision 2023
LP109	LP109 Revision 2023
LQ104	LQ104 Revision 2023

THE COMMON SEAL of EAST SUSSEX )  
COUNTY COUNCIL was affixed )  
hereto on the 2<sup>nd</sup> day of June two )  
thousand and twenty-three )  
in the presence of:- )

Authorised Signatory

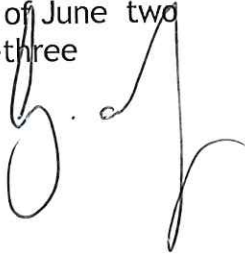

1025548

H & T Ctte. 2.4.74 - para 4.2 joint report of Director of  
Legal & Community Services & County Engineer - para 4.

The East Sussex Lewes Town (Parking Places and Waiting and Loading Restrictions)  
Traffic Regulation Order 2014 Amendment No 2 Order 2023

# The Order Plans

## Amendments

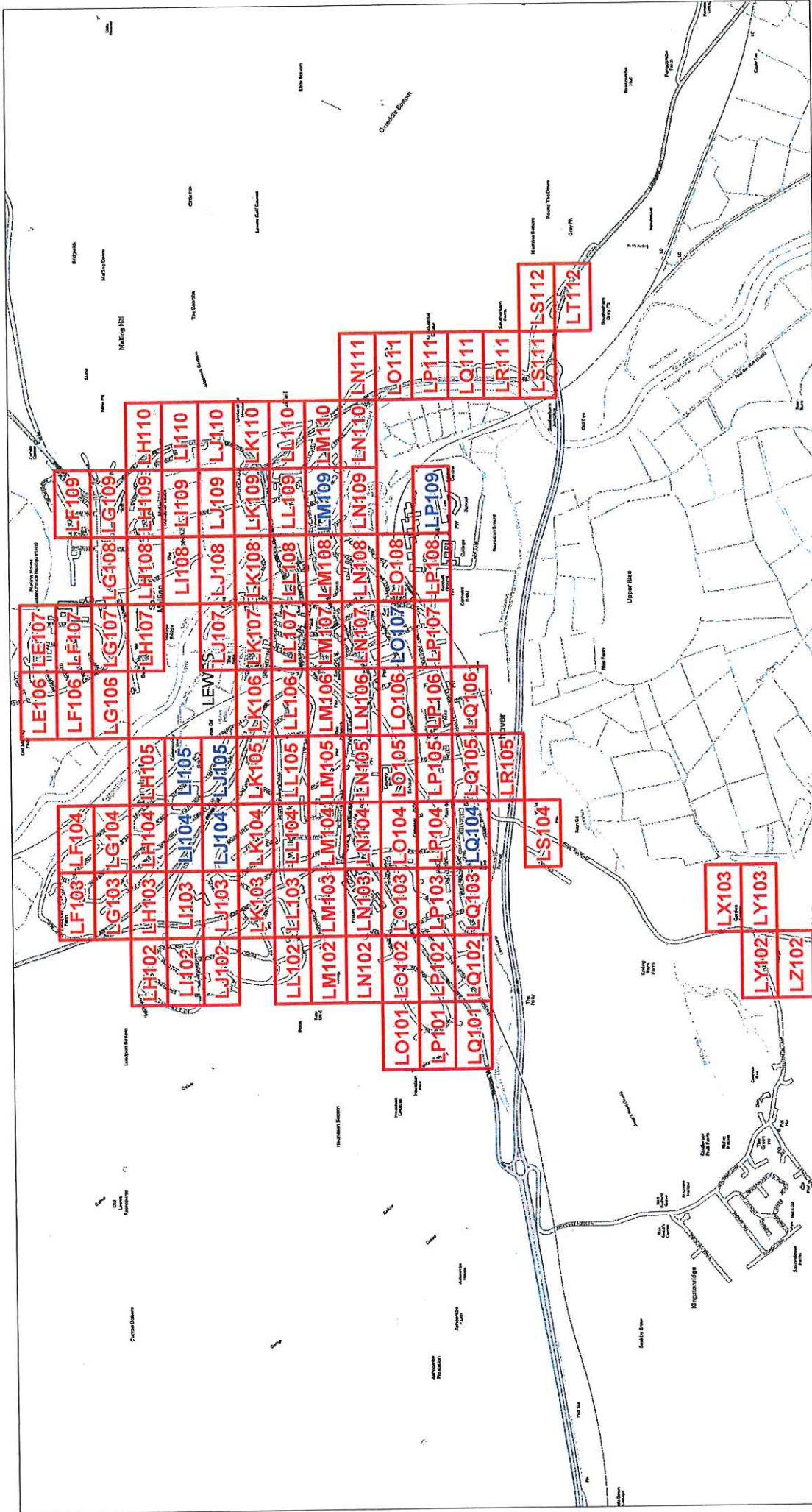

Locations of Parking and Waiting Restrictions

- LR000 Existing Tile
- LR000 Revised Tile

The East Sussex Lewes Town  
(Parking Places and Waiting and  
Loading Restrictions) Traffic  
Regulation Order 2014  
Amendment No 2 Order 2023



SCALE	1:22,500
DATE	21/09/2022
Title Ref: Overview Revision: 2023	

© Crown copyright. All rights reserved  
East Sussex County Council  
Licence No. 100019601 2023

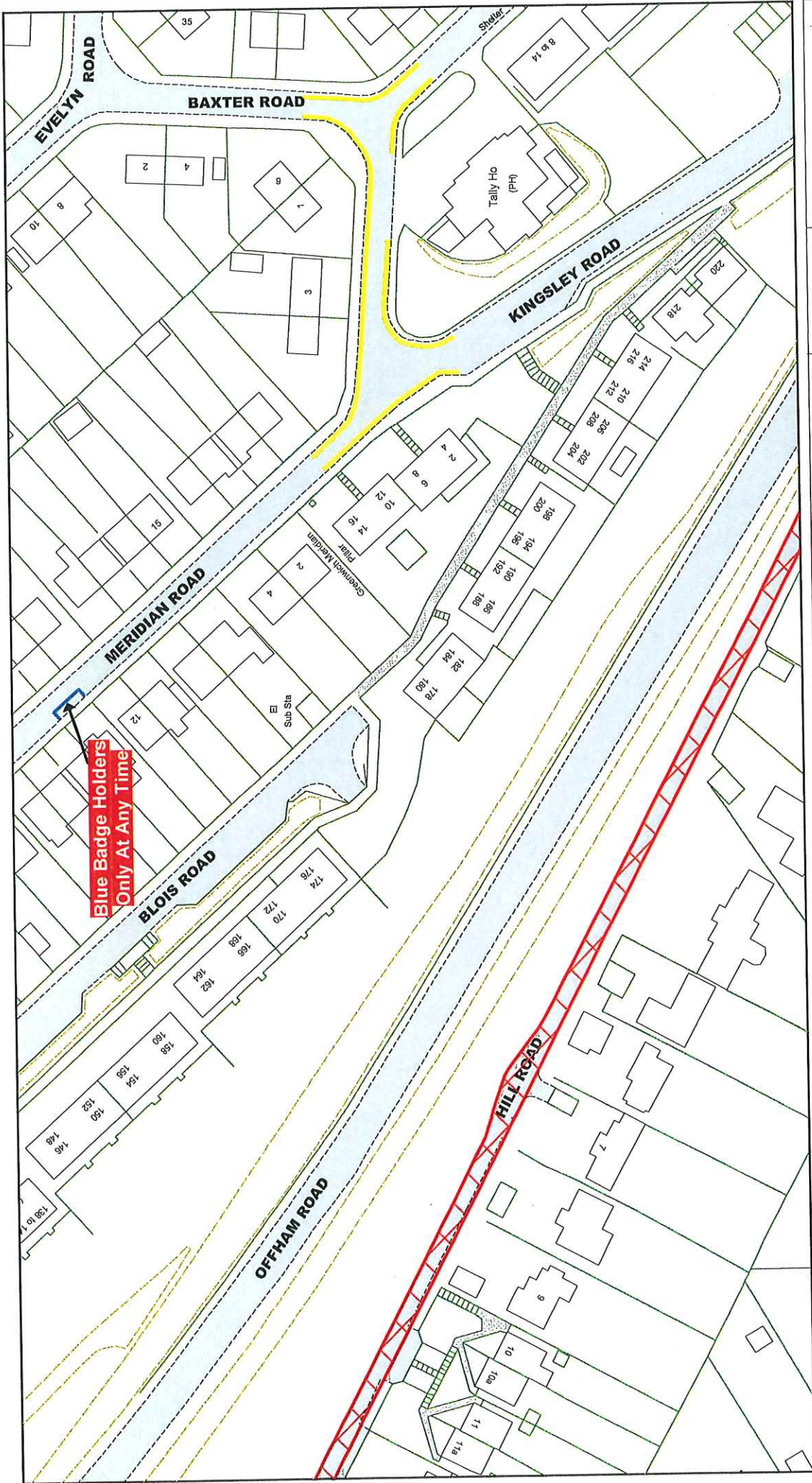

© Crown copyright. All rights reserved  
 East Sussex County Council  
 Licence No. 100019601 2023

**East Sussex County Council**

The East Sussex Lewes Town (Parking Places and Waiting and Loading Restrictions) Traffic Regulation Order 2014 Amendment No 2 Order 2023

**Key to Non TRO Items**

- Pedestrian Crossing (controlled area)
- Pedestrian Crossing Point
- Bus Stop/ Stand Clearway

**Key to TRO Restriction Types**

- No Waiting at Any Time
- No Waiting
- No Loading at Any Time
- No Loading
- Pay and Display
- Permit Holders Only
- Permit Holders or Pay and Display
- Permit Holders or Time Limited
- Limited Waiting
- Disabled Badge Holders Only

**Key to Labels**

- Proposed New or Change to Permanent TRO restriction
- Permanent TRO restriction
- Proposed New or Change to Non TRO item
- Proposed No Waiting At Any Time
- Proposed removal of No Waiting At Any Time

**Taxi Only**

- Motorcycles Only
- Loading/ Unloading Only
- Car Club Permit Only
- No Stopping on Footway or Verge
- No Waiting Vehicles over 5 tonnes gross weight
- No Stopping On Entrance Markings
- Restricted Parking Zone
- No Waiting at Any Time

**Adjacent Map Title**

- LH104
- LI103
- LI105
- LJ104

**SCALE** 1 : 1000

**DATE** 21/09/2022

**Title Ref:** LI104  
**Revision:** 2023

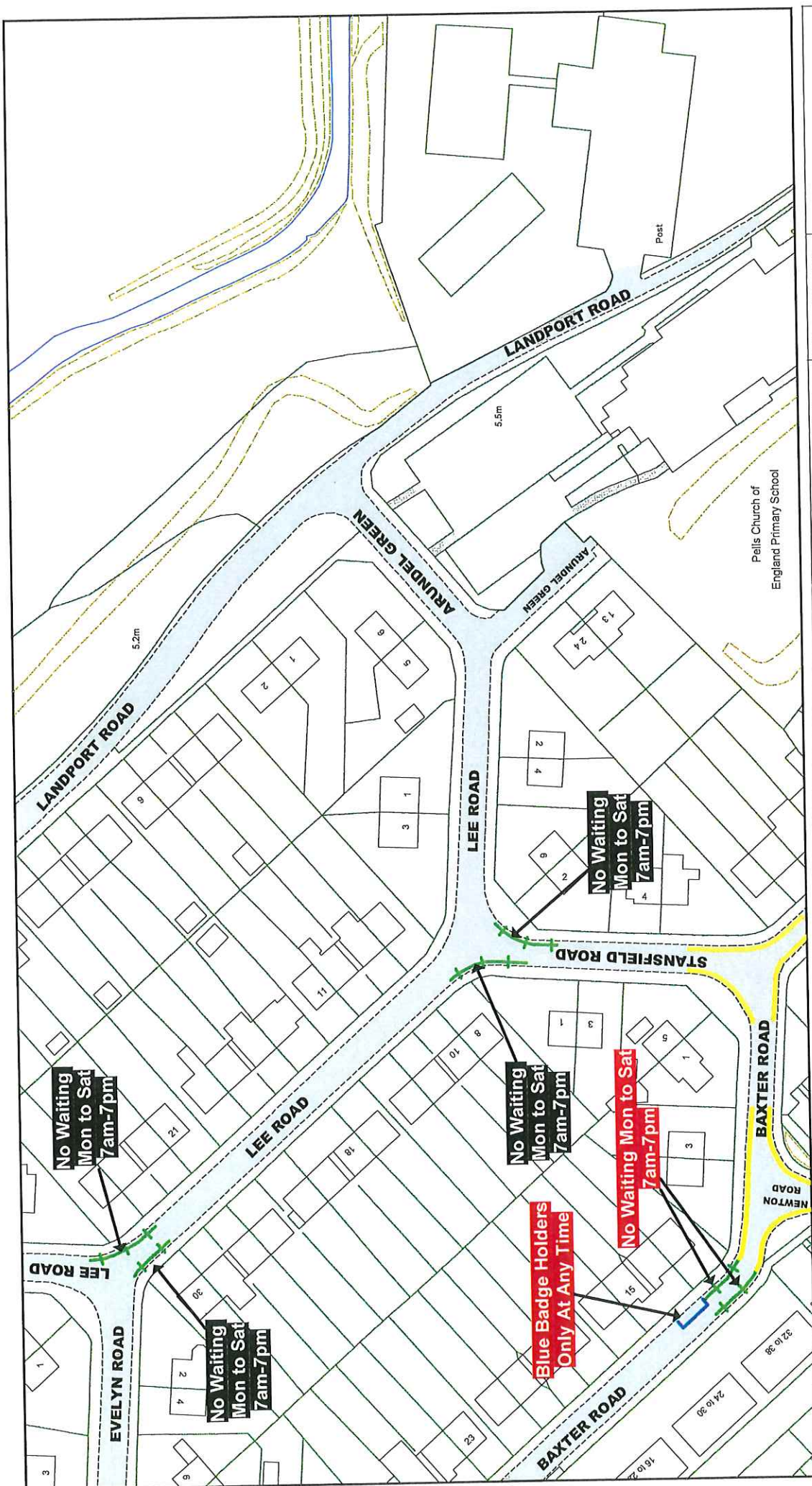

© Crown copyright. All rights reserved East Sussex County Council Licence No. 100019601 2023	<b>East Sussex</b> County Council		The East Sussex Lewes Town (Parking Places and Waiting and Loading Restrictions) Traffic Regulation Order 2014 Amendment No 2 Order 2023	<b>Key to Non TRO Items</b> Pedestrian Crossing (controlled area) Pedestrian Crossing Point Bus Stop/ Stand Clearway
			<b>Key to TRO Restriction Types</b> No Waiting at Any Time No Waiting No Loading at Any Time No Loading Pay and Display Permit Holders Only Permit Holders of Pay and Display Permit Holders or Time Limited Limited Waiting Disabled Badge Holders Only	<b>Key to Labels</b> <b>ABCD</b> Proposed New or Change to Permanent TRO restriction <b>ABCD</b> Permanent TRO restriction <b>ABCD</b> Non TRO item <b>ABCD</b> Proposed New or Change to Non TRO item Proposed No Waiting At Any Time Proposed removal of No Waiting At Any Time
The East Sussex Lewes Town (Parking Places and Waiting and Loading Restrictions) Traffic Regulation Order 2014 Amendment No 2 Order 2023			<b>Adjacent Map Title</b> LH105 LI104 LJ105	SCALE 1 : 1000 DATE 21/09/2022 Tile Ref: LI105 Revision: 2023

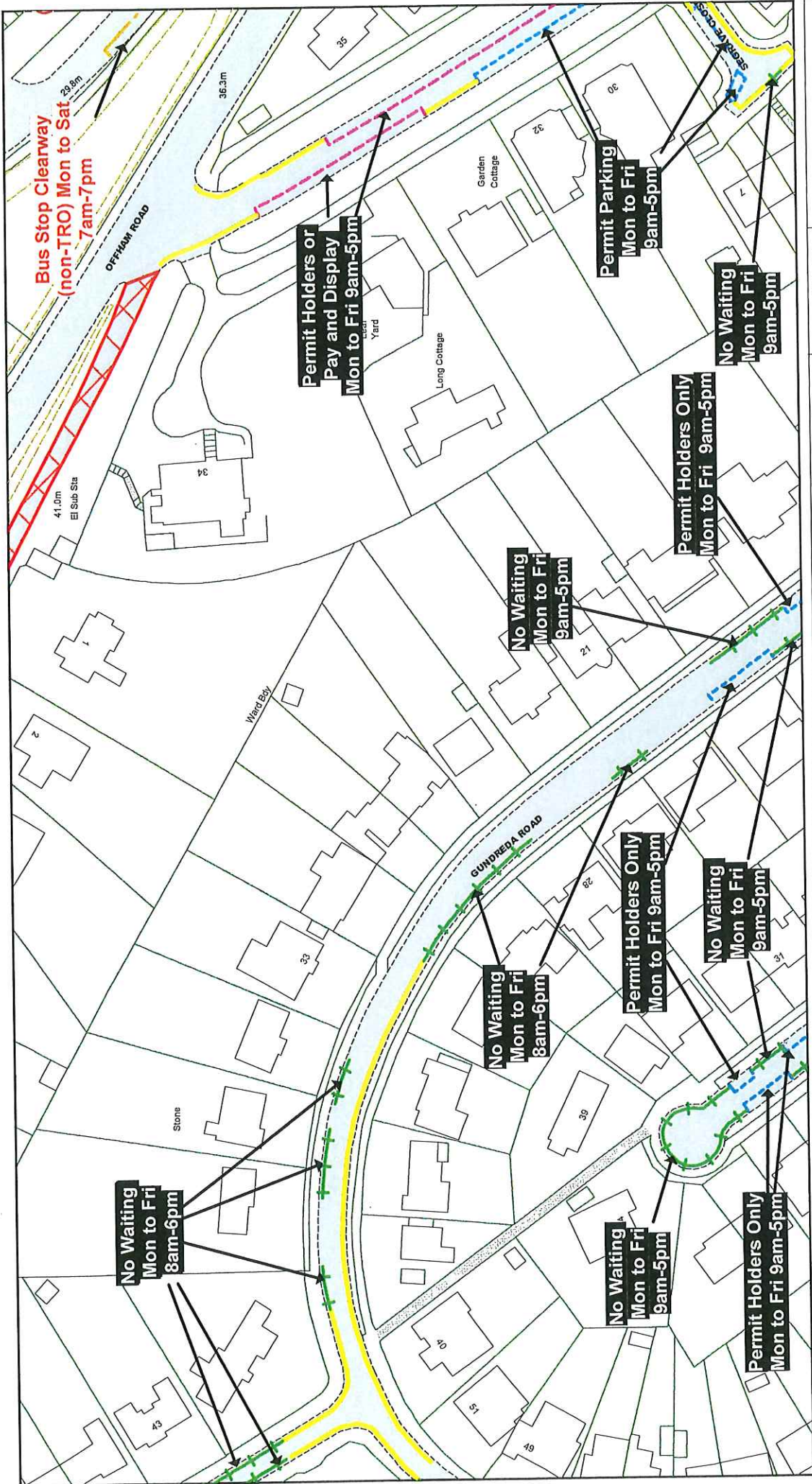

© Crown copyright. All rights reserved East Sussex County Council Licence No. 100019601 2023	<b>East Sussex</b> County Council		The East Sussex Lewes Town (Parking Places and Waiting and Restrictions) Traffic Regulation Order 2014 Amendment No 2 Order 2023	<b>Key to Non TRO Items</b> Pedestrian Crossing (controlled area) Pedestrian Crossing Point Bus Stop/ Stand Clearway
			<b>Key to TRO Restriction Types</b> No Waiting at Any Time No Waiting No Loading at Any Time No Loading Pay and Display Permit Holders Only Permit Holders or Pay and Display Permit Holders or Time Limited Limited Waiting Disabled Badge Holders Only	<b>Key to Labels</b> <b>ABCD</b> Proposed New or Change to Permanent TRO restriction <b>ABCD</b> Permanent TRO restriction <b>ABCD</b> Non TRO item <b>ABCD</b> Proposed New or Change to Non TRO item Proposed No Waiting At Any Time Proposed removal of Restricted Parking Zone No Waiting At Any Time
SCALE 1 : 1000 DATE 21/09/2022 Title Ref: LJ104 Revision: 2023		N W E S		

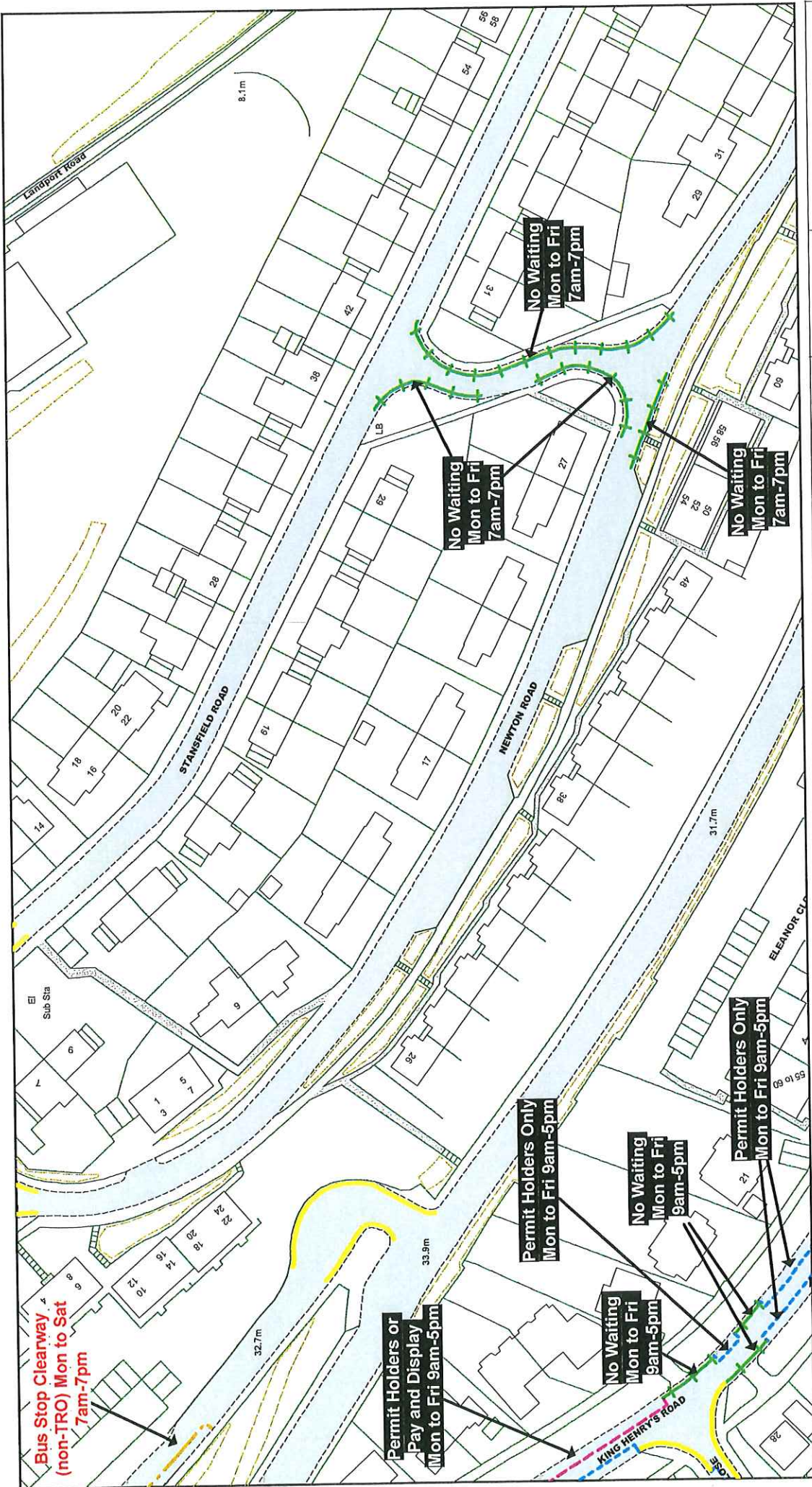

© Crown copyright. All rights reserved East Sussex County Council Licence No. 100019601 2023	<b>East Sussex</b> County Council		The East Sussex Lewes Town (Parking Places and Waiting and Loading Restrictions) Traffic Regulation Order 2014 Amendment No 2 Order 2023	<b>Key to Non TRO Items</b> Pedestrian Crossing (controlled area) Pedestrian Crossing Point Bus Stop/ Stand Clearway
			<b>Key to TRO Restriction Types</b> No Waiting at Any Time No Waiting No Loading at Any Time No Loading Pay and Display Permit Holders Only Permit Holders of Time Limited Permit Holders or Pay and Display Limited Waiting Disabled Badge Holders Only	<b>Key to Labels</b> Proposed New or Change to Permanent TRO restriction Permanent TRO restriction Proposed New or Change to Non TRO item Proposed No Waiting At Any Time Proposed removal of No Waiting At Any Time
SCALE 1 : 1000 DATE 21/09/2022 Title Ref: LJ105 Revision: 2023			N  S	



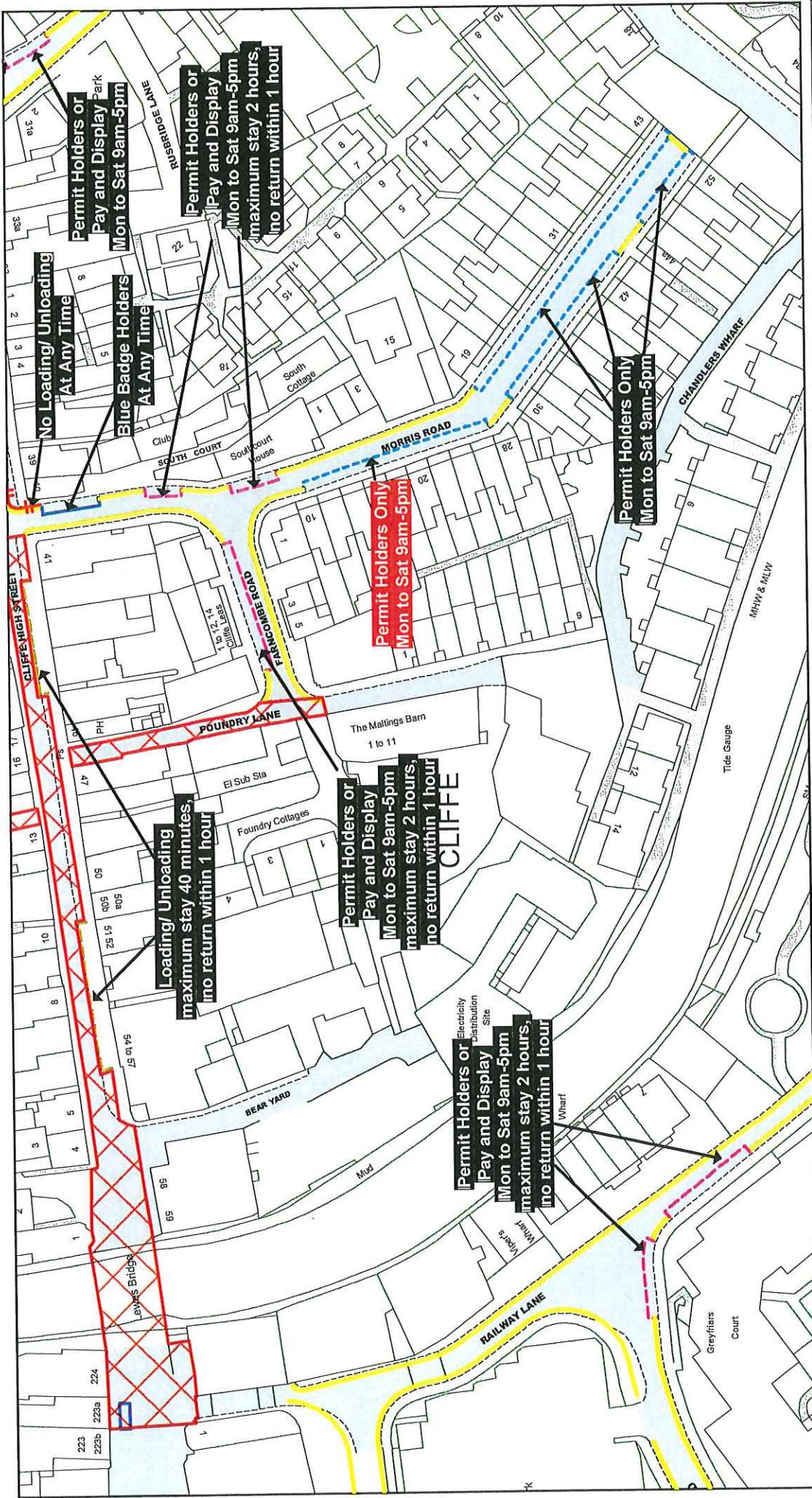

© Crown copyright. All rights reserved  
 East Sussex County Council  
 Licence No. 100019601 2023

**East Sussex County Council**

The East Sussex Lewes Town (Parking Places and Waiting and Loading Restrictions) Traffic Regulation Order 2014 Amendment No 2 Order 2023

**Key to Non TRO Items**

- Pedestrian Crossing (controlled area)
- Pedestrian Crossing Point
- Bus Stop/ Stand Clearway

**Key to TRO Restriction Types**

- No Waiting at Any Time
- No Loading at Any Time
- Pay and Display
- Permit Holders Only
- Permit Holders or Pay and Display
- Permit Holders or Time Limited
- Limited Waiting
- Disabled Badge Holders Only

**Key to Labels**

- Proposed New or Change to Permanent TRO restriction
- Permanent TRO restriction
- Proposed New or Change to Non TRO item
- Proposed No Waiting At Any Time
- Proposed removal of No Waiting At Any Time

**Key to TRO Restriction Types**

- Taxi Only
- Motorcycles Only
- Loading/ Unloading Only
- Car Club Permit Only
- No Stopping on Footway or Verge
- No Waiting Vehicles over 5 tonnes gross weight
- No Stopping On Entrance Markings
- Restricted Parking Zone
- No Waiting at Any Time

**Key to Labels**

- ABCD Proposed New or Change to Permanent TRO restriction
- ABCD Permanent TRO restriction
- ABCD Non TRO item
- ABCD Proposed New or Change to Non TRO item

**Adjacent Map Title**

- LL109
- LM108
- LM110
- LN109

SCALE: 1 : 1000  
 DATE: 21/09/2022  
 Title Ref: LM109  
 Revision: 2023

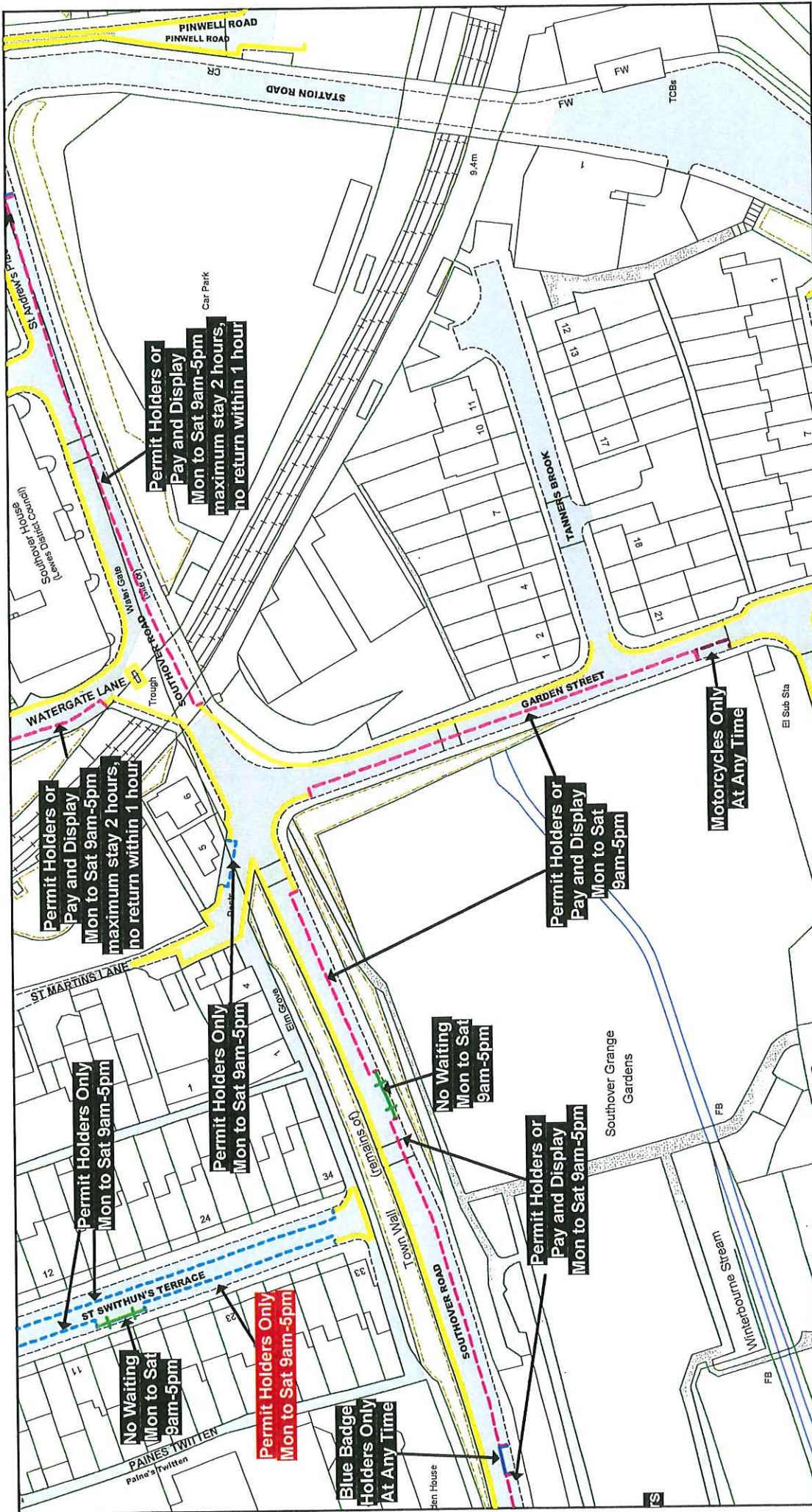

<p>© Crown copyright. All rights reserved East Sussex County Council Licence No. 100019601, 2023</p> <p><b>East Sussex</b> County Council</p>		<p>The East Sussex Lewes Town (Parking Places and Waiting and Loading Restrictions) Traffic Regulation Order 2014 Amendment No 2 Order 2023</p> <p><b>Key to Non TRO Items</b>   Pedestrian Crossing (controlled area)   Pedestrian Crossing Point   Bus Stop/Stand Cleanway</p>		<p><b>Key to TRO Restriction Types</b></p> <ul style="list-style-type: none"> <li>No Waiting at Any Time</li> <li>No Waiting</li> <li>No Loading at Any Time</li> <li>No Loading</li> <li>Pay and Display</li> <li>Permit Holders Only</li> <li>Permit Holders or Pay and Display</li> <li>Permit Holders or Time Limited</li> <li>Limited Waiting</li> <li>Disabled Badge Holders Only</li> </ul>		<p><b>Key to Labels</b></p> <ul style="list-style-type: none"> <li>ABCD Proposed New or Change to Permanent TRO restriction</li> <li>ABCD Permanent TRO restriction</li> <li>ABCD Non TRO item</li> <li>ABCD Proposed New or Change to Non TRO item</li> <li>Proposed No Waiting At Any Time</li> <li>Proposed removal of No Waiting At Any Time</li> </ul>		<p><b>Adjacent Map Title</b></p> <ul style="list-style-type: none"> <li>LN107</li> <li>LO106</li> <li>LO108</li> <li>LP107</li> </ul>		<p>SCALE 1 : 1000</p> <p>DATE 21/09/2022</p> <p>Title Ref: LO107 Revision: 2023</p>	
---	--	--	--	--	--	---	--	---	--	---	--

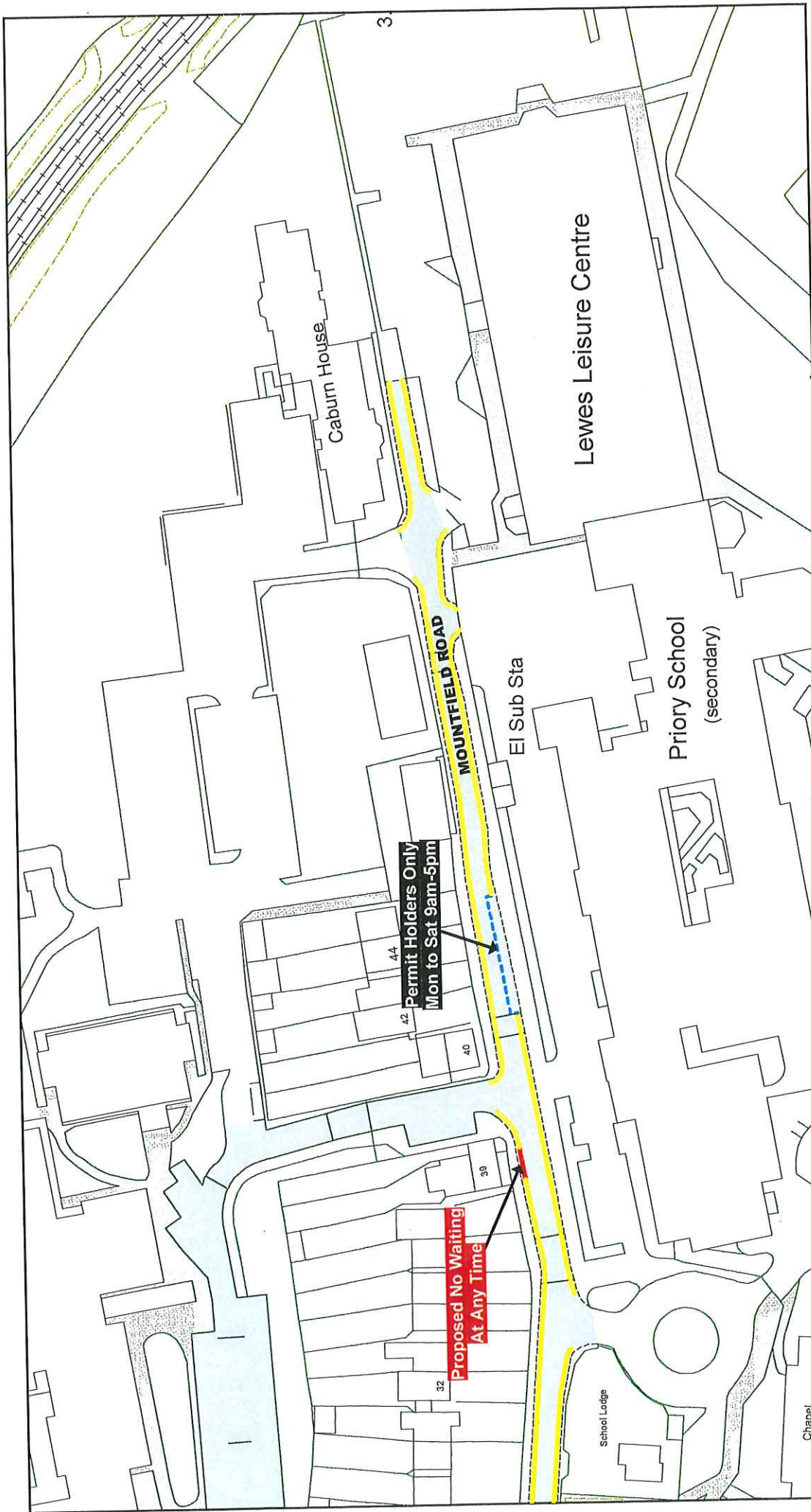

<p>© Crown copyright. All rights reserved          East Sussex County Council          Licence No. 100019601 2023</p> <p><b>East Sussex</b>          County Council</p> 	<p>The East Sussex Lewes Town          (Parking Places and Waiting and          Loading Restrictions) Traffic          Regulation Order 2014          Amendment No 2 Order 2023</p> <p><b>Key to Non TRO Items</b></p> <ul style="list-style-type: none"> <li>Pedestrian Crossing (controlled area)</li> <li>Pedestrian Crossing Point</li> <li>Bus Stop/ Stand Cleanway</li> </ul>	<p><b>Key to TRO Restriction Types</b></p> <ul style="list-style-type: none"> <li>No Waiting at Any Time</li> <li>No Waiting</li> <li>No Loading at Any Time</li> <li>No Loading</li> <li>Pay and Display</li> <li>Permit Holders Only</li> <li>Permit Holders or Pay and Display</li> <li>Permit Holders or Time Limited</li> <li>Limited Waiting</li> <li>Disabled Badge Holders Only</li> </ul>	<p><b>Key to Labels</b></p> <ul style="list-style-type: none"> <li>ABCD Proposed New or Change to Permanent TRO restriction</li> <li>ABCD Permanent TRO restriction</li> <li>ABCD Non TRO item</li> <li>ABCD Proposed New or Change to Non TRO item</li> </ul>	<p><b>Key to Labels</b></p> <ul style="list-style-type: none"> <li>Proposed New or Change to Permanent TRO restriction</li> <li>Permanent TRO restriction</li> <li>Non TRO item</li> <li>Proposed New or Change to Non TRO item</li> <li>Proposed No Waiting At Any Time</li> <li>Proposed removal of No Waiting At Any Time</li> </ul>	<p>Adjacent Map Title</p> <p><b>LP108</b></p>	<p>SCALE 1 : 1000</p> <p>DATE 21/09/2022</p> <p>Title Ref: LP109          Revision: 2023</p>
---	---	--	--	---	---	--

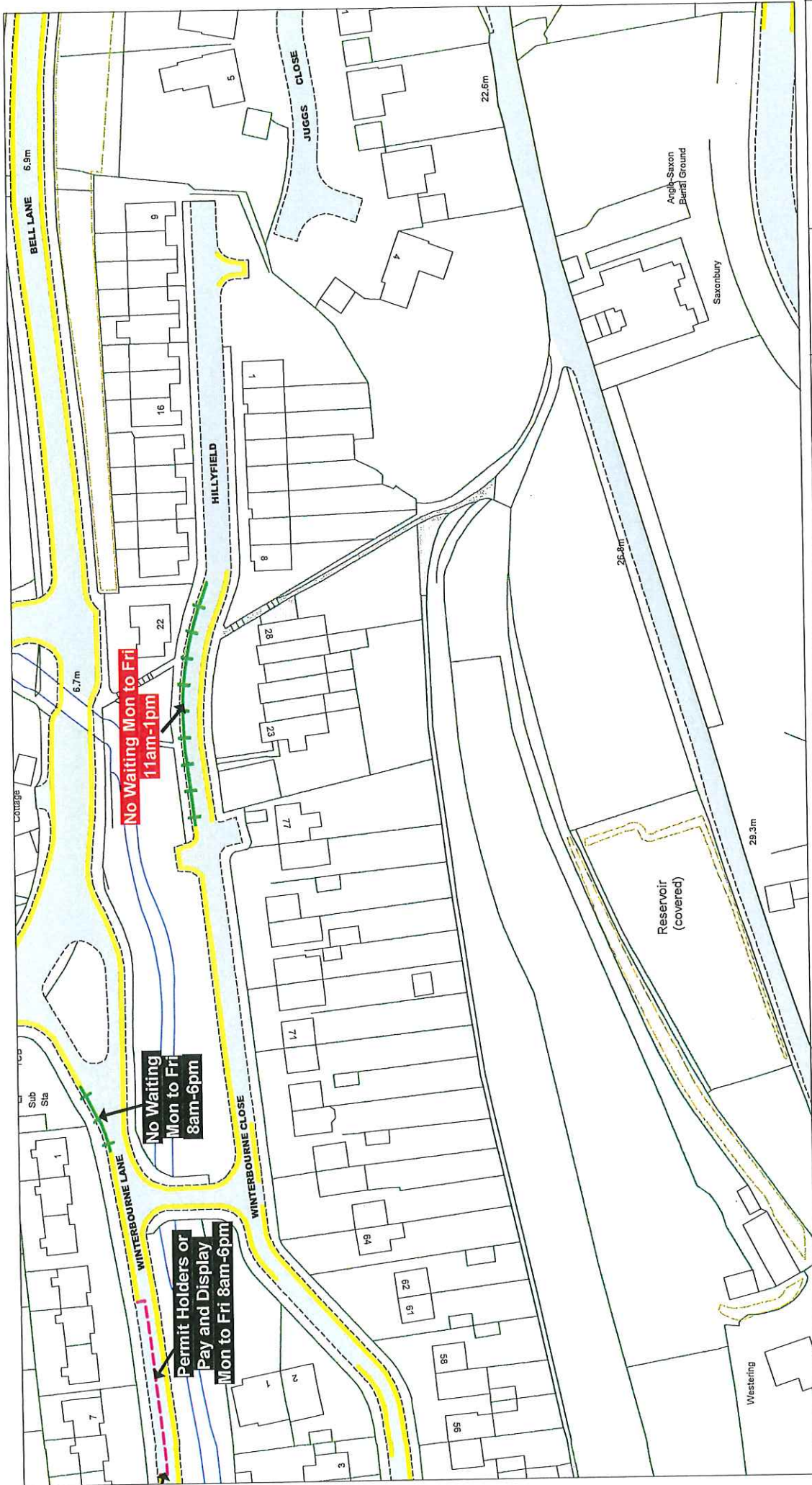

© Crown copyright. All rights reserved East Sussex County Council Licence No. 100019601 2023	<b>The East Sussex Lewes Town (Parking Places and Waiting and Loading Restrictions) Traffic Regulation Order 2014 Amendment No 2 Order 2023</b>		<b>Key to Non TRO Items</b> Pedestrian Crossing (controlled area) Pedestrian Crossing Point Bus Stop/ Stand Cleanway	
	<b>Key to TRO Restriction Types</b> No Waiting at Any Time No Waiting No Loading at Any Time No Loading Pay and Display Permit Holders Only Permit Holders or Pay and Display Permit Holders or Time Limited Limited Waiting Disabled Badge Holders Only		<b>Key to Labels</b> ABCD Proposed New or Change to Permanent TRO restriction ABCD Permanent TRO restriction ABCD Non TRO item ABCD Proposed New or Change to Non TRO item Proposed No Waiting At Any Time Proposed removal of No Waiting At Any Time	
<b>Key to TRO Restriction Types</b> Motorcycles Only Loading/ Unloading Only Car Club Permit Only No Stopping on Footway or Verge No Waiting Vehicles over 5 tonnes gross weight No Stopping On Entrance Markings Restricted Parking Zone No Waiting at Any Time		<b>Adjacent Map Title</b> LP104 LQ103 LQ105		
<b>East Sussex County Council</b>		SCALE 1 : 1000	DATE 21/09/2022	
<b>East Sussex County Council</b>		Title Ref: LQ104 Revision: 2023		