

**The East Sussex Lewes Town (Parking Places and Waiting and Loading Restriction)  
Traffic Regulation Order 2014 Amendment No \* Order 202\*  
(Pelham Terrace)**

# **The Order Plans**

## **Amendments**

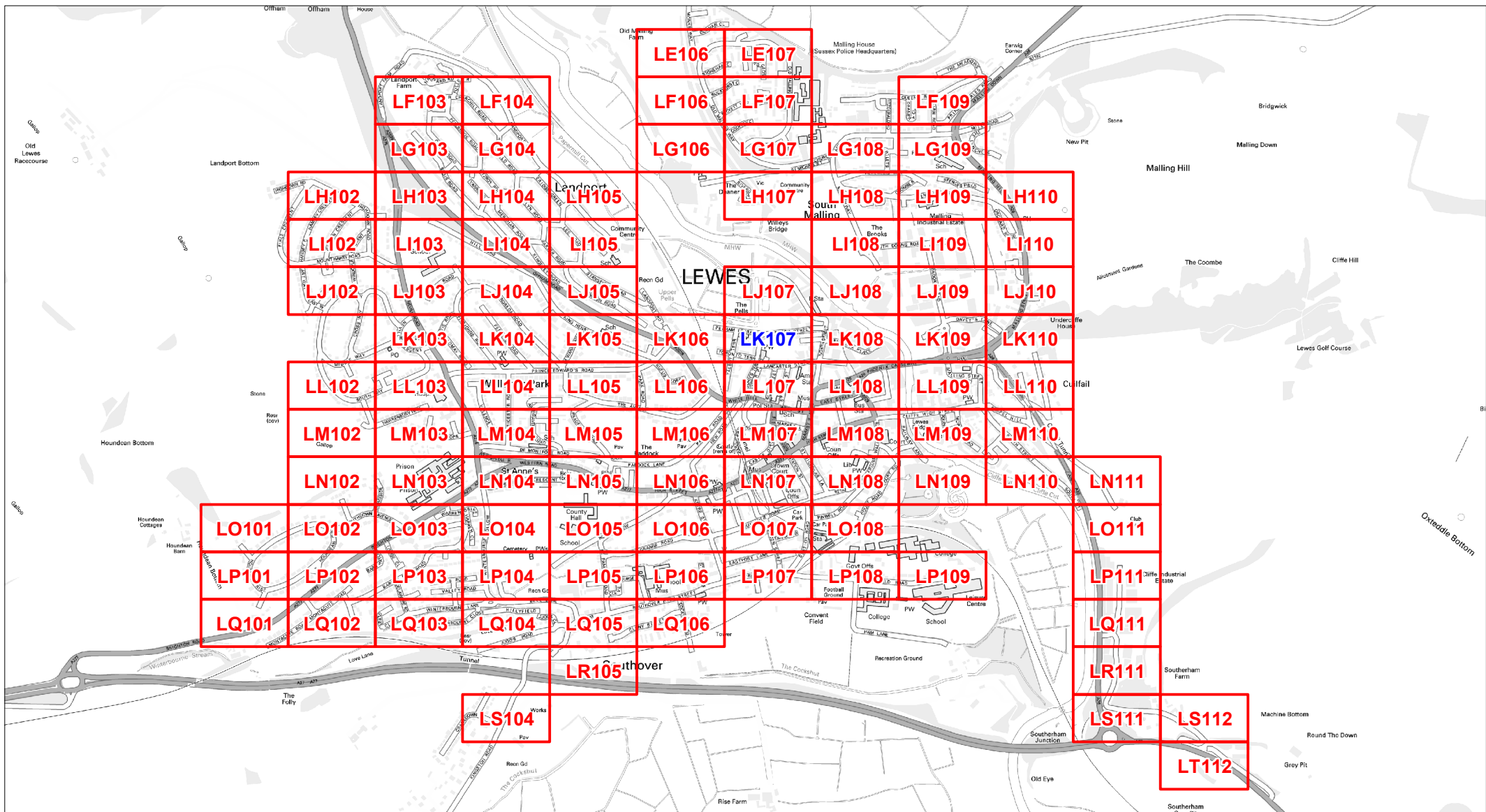

The East Sussex (Lewes Town)  
(Parking Places and Waiting and  
Loading Restriction) Traffic  
Regulation Order 2014  
Amendment No.\* Order 202\*  
(Pelham Terrace)

### Locations of Parking and Waiting Restrictions

- LR000 Existing Tile
- LR000 Revised Tile

© Crown copyright. All rights reserved  
East Sussex County Council  
Licence No. 100019601 2022



SCALE	1:22,500
DATE	04/08/2022
Tile Ref: Overview	Revision: *

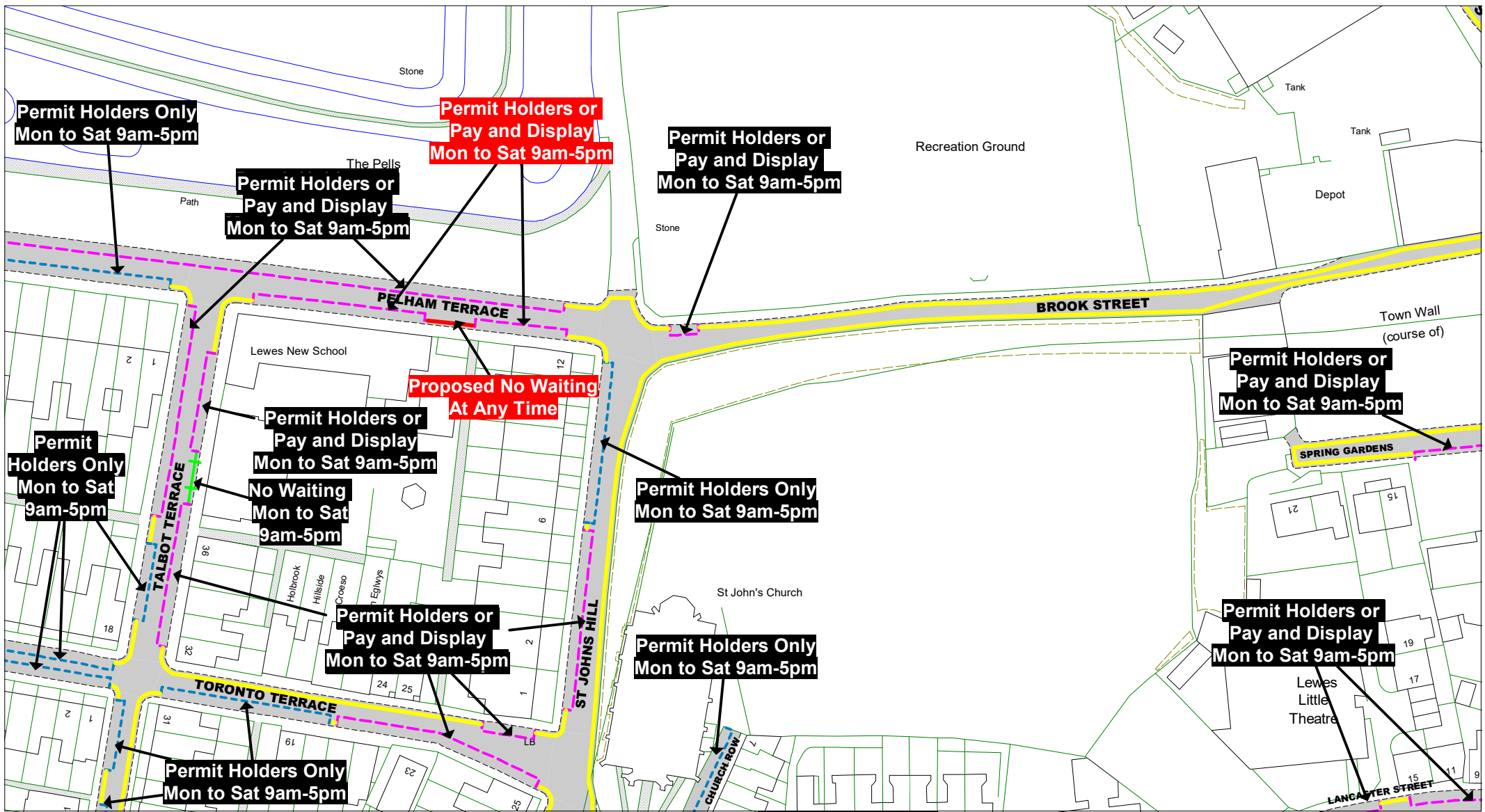

© Crown copyright. All rights reserved  
 East Sussex County Council  
 Licence No. 100019601 2022

**East Sussex**  
 County Council



The East Sussex Lewes Town  
 (Parking Places and Waiting and  
 Loading Restrictions) Traffic  
 Regulation Order 2014 Amendment  
 Order No.\* 202\* (Pelham Terrace)

**Key to Non TRO Items**

- Pedestrian Crossing (controlled area)
- Pedestrian Crossing Point
- Bus Stop/ Stand Clearway

**Key to TRO Restriction Types**

- No Waiting at Any Time
- No Waiting
- No Loading at Any Time
- No Loading at Any Time Pay and Display
- Permit Holders Only
- Permit Holders or Pay and Display
- Permit Holders or Time Limited
- Limited Waiting
- Disabled Badge Holders Only

- Taxi Only
- Motorcycles Only
- Loading/ Unloading Only
- Car Club Permit Only
- No Stopping on Footway or Verge
- No Waiting Vehicles over 5 tonnes gross weight
- No Stopping On Entrance Markings
- Restricted Parking Zone No Waiting at Any Time

**Key to Labels**

- Proposed New or Change to Existing Permanent TRO restriction
- Proposed Permanent TRO restriction
- Non TRO item
- Proposed No Waiting At Any Time
- Proposed removal of No Waiting At Any Time

**Adjacent Map Tile**

- LJ107
- LK106
- LK108
- LL107



SCALE 1 : 1000  
 DATE 04/08/2022

Tile Ref: LK107  
 Revision: \*