

Phase 2 of the Eastbourne Town Centre Movement & Access Package

Engagement brochure and survey

East Sussex County Council and
Eastbourne Borough Council



Introduction

East Sussex County Council and Eastbourne Borough Council are committed to ensuring Eastbourne Town Centre remains an attractive and prosperous place to live, work and visit whilst supporting the growth of the local economy.

The Eastbourne Town Centre Movement & Access Package is a joint project that will enhance and promote the vitality of the Town Centre.

Phase 1 has involved pedestrian, public transport and public realm improvements around Eastbourne Rail Station, the section of Terminus Road between Ashford Road and Bankers Corner as well as in Cornfield Road and Gildredge Road, to create an attractive and contemporary welcome to visitors arriving to the town and outside the extension to The Beacon shopping centre. The work is due to complete in November 2019 and attention now turns to Phase 2 of the scheme, which extends through the Town Centre towards the seafront.

Between 12 November and 10 December 2019 we are welcoming feedback on the Phase 2 proposals. This brochure contains our proposals and details on how you can have your say.

Town Centre Local Plan

The Eastbourne Borough Council Town Centre Local Plan (TCLP) is a document that outlines the planning framework for the Town Centre between 2013 and 2027.

These proposed improvements will help us to deliver the core objectives of the Borough Council's Town Centre Local Plan. These objectives include:

- Modernising the Town Centre
- Creating a Town Centre environment which prioritises pedestrians
- Creating new civic spaces which can be used for cultural and social activities
- Promote local economic growth by revitalising the Town Centre, attracting new businesses and visitors to the town.

The Town Centre Local Plan can be found at:
www.lewes-eastbourne.gov.uk/planning-policy/eastbourne-town-centre-local-plan/

East Sussex Local Transport Plan (LTP) 2011-2026 and LTP Implementation Plan 2016/17 – 2020/21

The East Sussex Local Transport Plan 2011 – 2026 sets out our vision and objectives, and the strategy for investing in transport infrastructure up to 2026.

The Plan is supported by a series of five-year implementation plans, the second of which covers the period 2016/17 to 2020/21 which set out the intentions for transport investment for this period of time. The current Implementation Plan includes the development and delivery of the Eastbourne Town Centre Movement and Access Package.

The proposed improvements will help us deliver the following LTP objectives:

- Improving economic competitiveness and growth
- Improve safety, health and security
- Improve accessibility and social inclusion

The East Sussex Local Transport Plan and its Implementation Plan for 2016/17 to 2020/21 can be found at: www.eastsussex.gov.uk/roadsandtransport/localtransportplan/ltp3/downloadltp3/

The story so far – Phase 1

In October 2011, East Sussex County Council (ESCC) and Eastbourne Borough Council (EBC) alongside Legal and General's proposals to extend the then Arndale Centre (now The Beacon), held a public exhibition and consultation looking at ways of improving the public realm and pedestrian environment in Terminus Road between Ashford Road and Bankers Corner as well as in Cornfield Road.

We used the feedback received to generate further proposals which we consulted on in 2013. These proposals included:

- Wider and upgraded pavements on Terminus Road and Cornfield Road
- The relocation of bus stops from Terminus Road to Cornfield Road, and subsequently also into Gildredge Road

- Provision of new bus stops outside the rail station
- Changes to the taxi rank outside the rail station.

The previous consultation responses showed clear support for these designs.

In 2014 East Sussex County Council were successful in securing £8m investment allocated for the Eastbourne Town Centre Movement & Access Package in the South East Local Enterprise Partnership (SE LEP) Local Growth Deal. Phase 1 has been delivered using £5m of the LEP funding alongside monies from the Borough Council, County Council, Network Rail and Legal & General, the developer of The Beacon.

Further stages of the Movement and Access Package for the Town Centre look at further improvements along Terminus Road through to the seafront, the Little Chelsea area and Memorial roundabout.

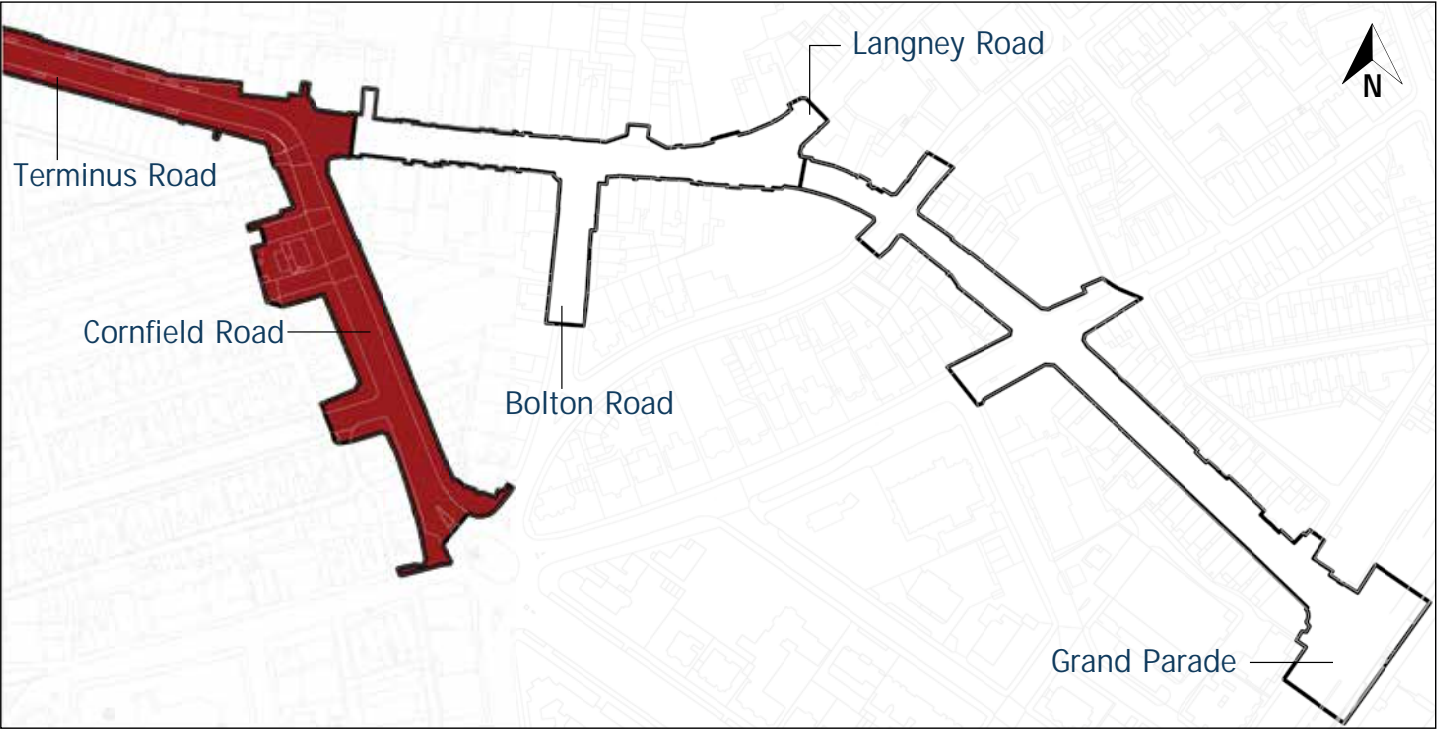

Phase 1 Scheme Boundaries

What are we proposing in Phase 2?

Phase 2 of the scheme begins at the junction of Cornfield Road and Terminus Road (referred to as “Bankers’ Corner”), continuing down the pedestrianised section of Terminus Road to Bolton Road and Langney Road.

Our objectives for Phase 2 are to:

- Deliver improvements which support and complement changes made in Phase 1
- Improve pedestrian safety and accessibility (ease of movement for disabled people and/or older people, families with pushchairs etc.) by reallocating road space to pedestrians

- Use Terminus Road to create a ‘spine route’ through the primary retail area of Eastbourne Town Centre to the seafront.
- Coordinate the design of street furniture and signage which will be finished to a high standard in the Town Centre
- Improve the public realm within the Town Centre

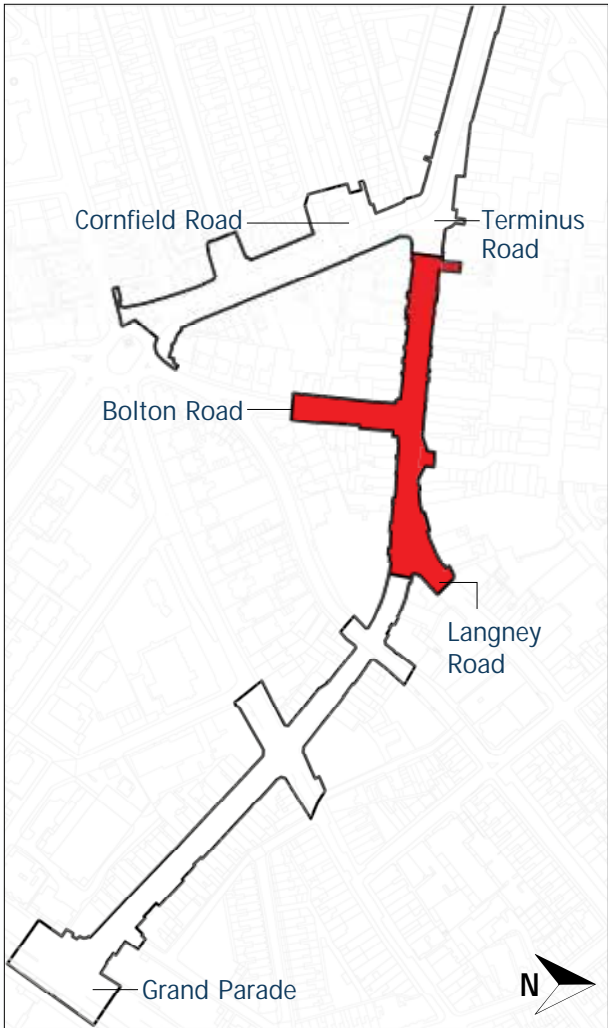

Phase 2 Scheme Boundaries

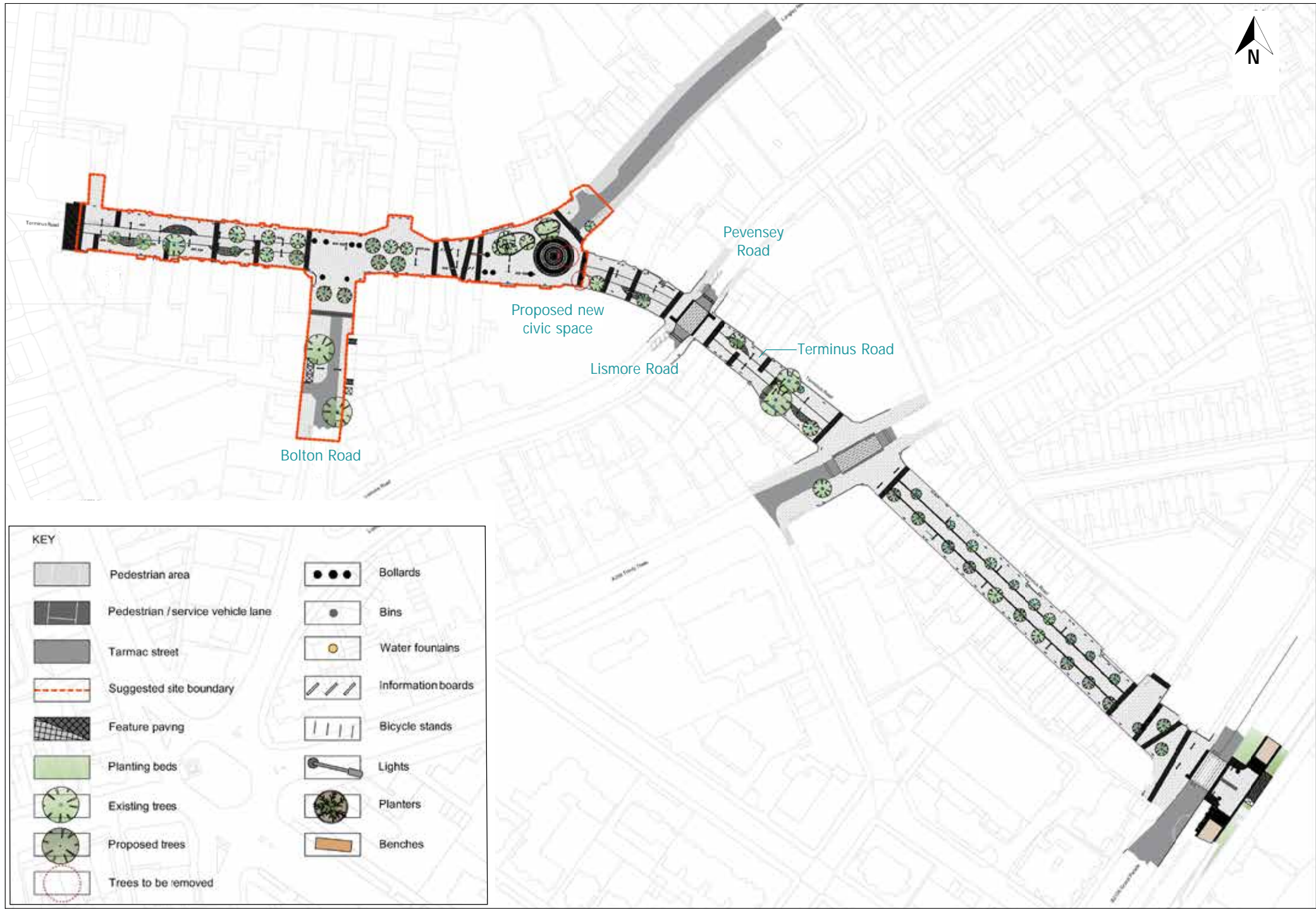

Overview of Phase 2 proposals

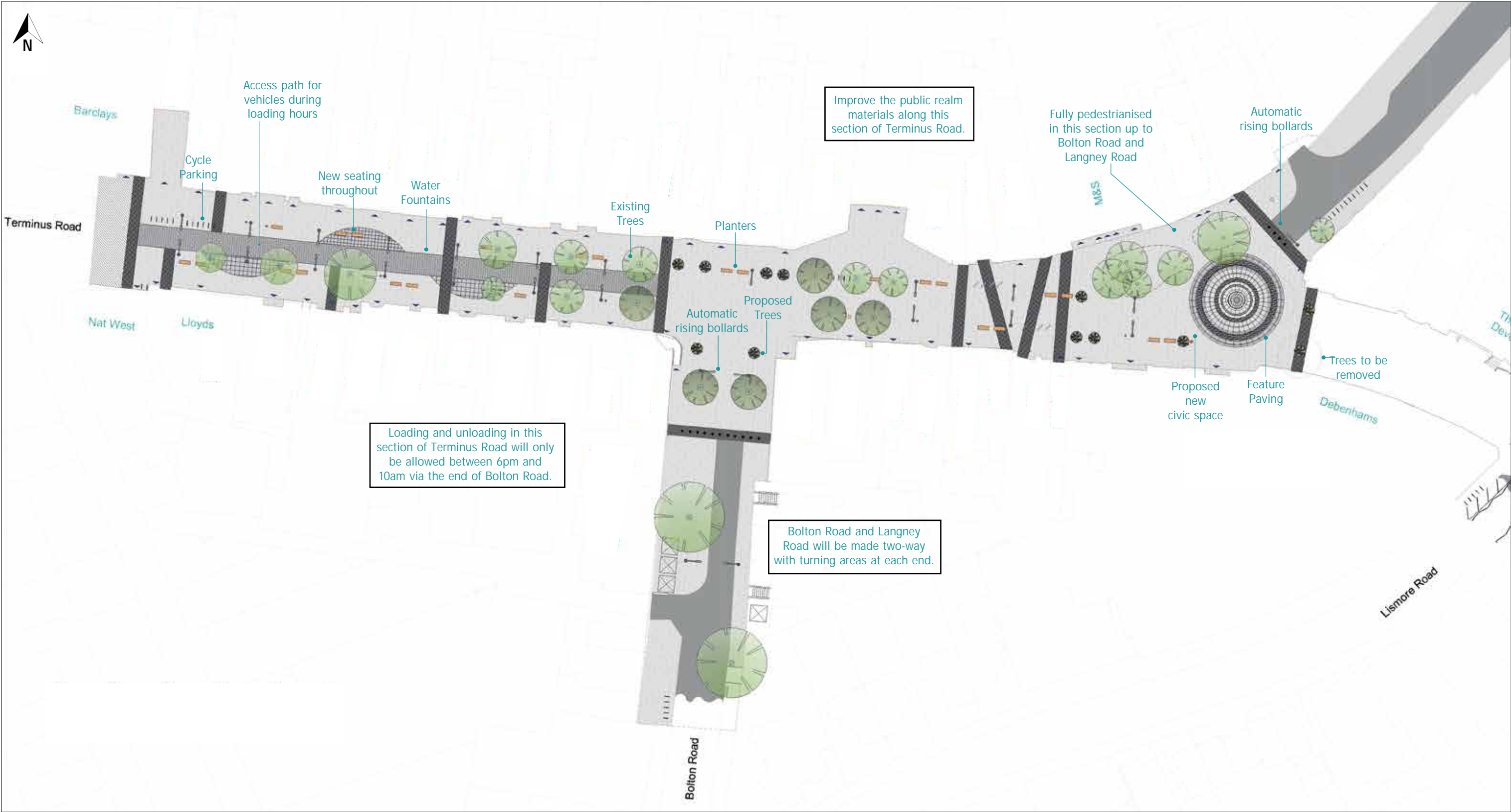

Phase 2 proposals in detail

What are the benefits?

Improve pedestrian safety and accessibility

Currently, there are only two designated crossing points for pedestrians across the section of Terminus Road between Bolton Road and Langney Road – one near the entrance into The Beacon and the other near the entrance to Marks and Spencer. In particular, the railings on either side of Terminus Road outside Marks and Spencer force pedestrians to the nearby crossing point which results in crowding. Our proposals remove vehicles from this section of Terminus Road and open this space for pedestrians. As a consequence, Bolton Road and Langney Road are both made two way in our proposals.

The current layout of street furniture (benches, bollards and cycle parking), trees and parked vehicles along the section of Terminus Road from Bankers Corner to Langney Road, further restrict pedestrian movements and restrict users with mobility issues accessing shops and services. Our proposals will declutter the area by replacing the existing street furniture with more comfortable benches and cycle parking.

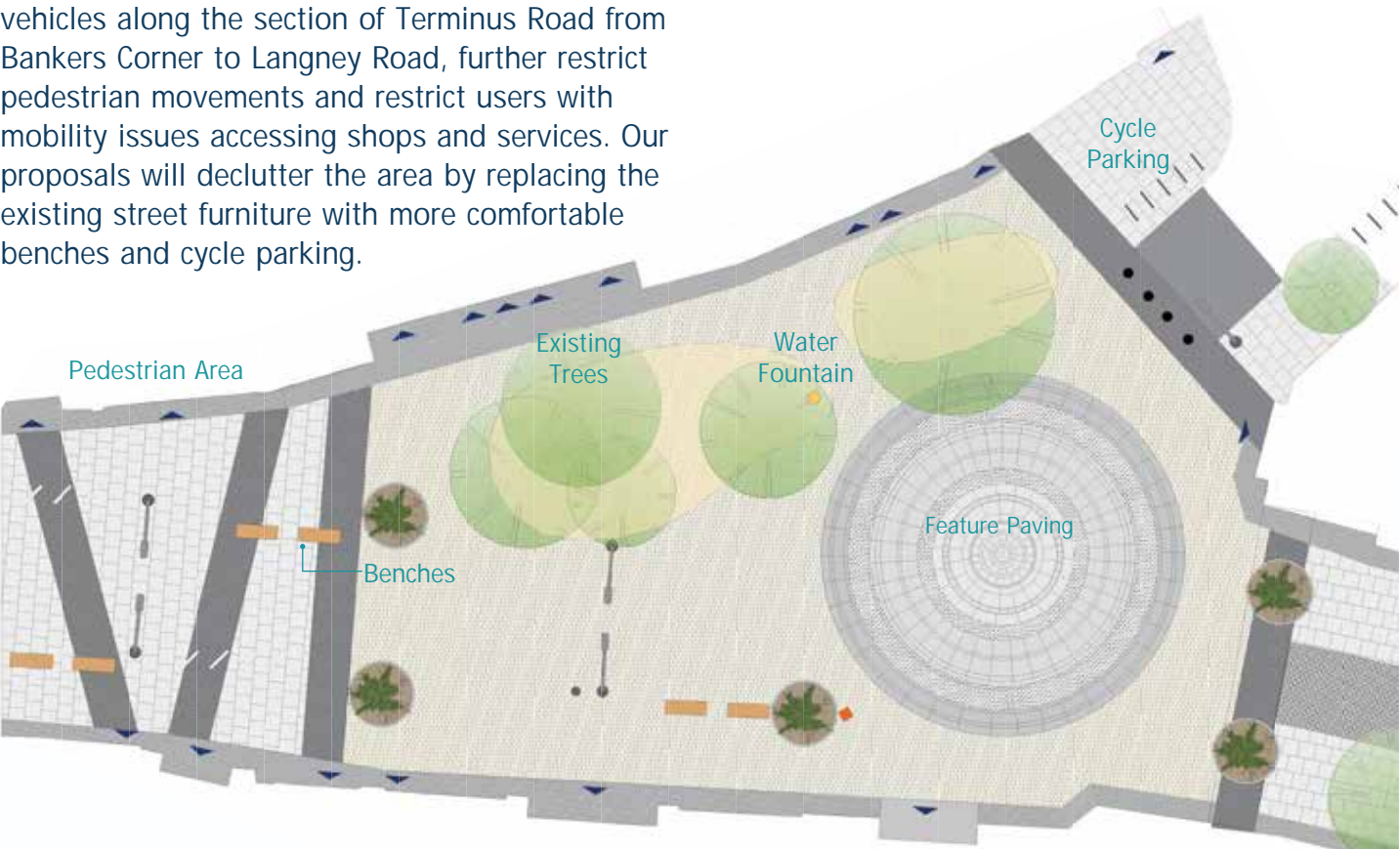

Proposals for a civic space

Help the Town Centre retail environment to thrive

Improvements for pedestrians from the train station through the Town Centre, including the pedestrianisation of Terminus Road between Bolton Road and Langney Road, are intended to increase footfall and help support retail and employment opportunities. The pedestrianisation of Terminus Road also enables the creation of a large civic space from opposite Nationwide Building Society to Marks and Spencer and Blacks.

We would like to hear your views on how part of this space could be designed and used. For example, it could become meeting or event spaces, feature public art or have play facilities.

Modernise the public spaces

Much of the existing paving in the area is in poor condition with uneven surfaces which hamper visitors, particularly those with mobility issues. As part of the proposals, the existing materials will be replaced with new paving which will compliment those materials used in Phase 1. Contrasting colour materials will be used to differentiate walkways and where vehicles can use for access and loading (mostly out of hours), and there will be no change of level. We also propose using flint paving in the proposed civic space. It improves the appearance of the current paving and as it's locally sourced, is more sustainable than other options too.



Example of a tree pit and cycle parking

Promote health and sustainable travel

To encourage sustainable travel to the Town Centre, new bicycle stands will be placed:

- Adjacent to Bankers Corner, opposite Lloyds Bank
- At the top of the pedestrianised area planned for Bolton Road, near Zizzi
- At the start of Langney Road at its junction with Terminus Road (opposite "Blacks")

The plans also include automatic rising bollards situated at two sites: the junction between Terminus Road and Langney Road (outside "Blacks"); and the junction between Bolton Road and Terminus Road (outside "Nationwide Building Society").

These will keep this stretch of Terminus Road entirely pedestrianised during trading hours but will also allow for delivery/servicing vehicles to access Terminus Road businesses via Bolton Road outside of trading hours. It is proposed that the current loading restrictions will remain unchanged and that Emergency Services will be able to control the bollards for access to the area in emergencies.

Removing vehicles from the section of Terminus Road between Bolton Road and Langney Road will have a positive impact on air quality.

What are the impacts?

Some parking spaces will be removed.

To achieve full pedestrianisation, both Langney Road and Bolton Road, which are currently one-way streets, will need to change to accommodate two-way traffic. To achieve this, turning areas will need to be installed at the end of each street. Due to limited space, this would result in the loss of parking bays in both roads.

We monitored the use of the current bays in April 2019 to identify what the average and peak usage as set out in the table below.

Type	Existing Capacity	Surveyed parking usage	
		Average usage	Peak usage
Taxi	18	4	8
Disabled	15	6	10
Pay & Display	24	8	14
Total	57	18	32

Results of our parking audit

At present there are 57 parking bays for taxis, disabled vehicles and pay and display. With the changes to Bolton Road and Langney Road, this would be reduced to 18 spaces. It is proposed to remove the 24 pay and display spaces. Therefore, the spaces available would be provided for taxis, disabled and loading only. The location and mix of the disabled and taxi bays will be decided after further consultation with the users and community.

When will this happen?

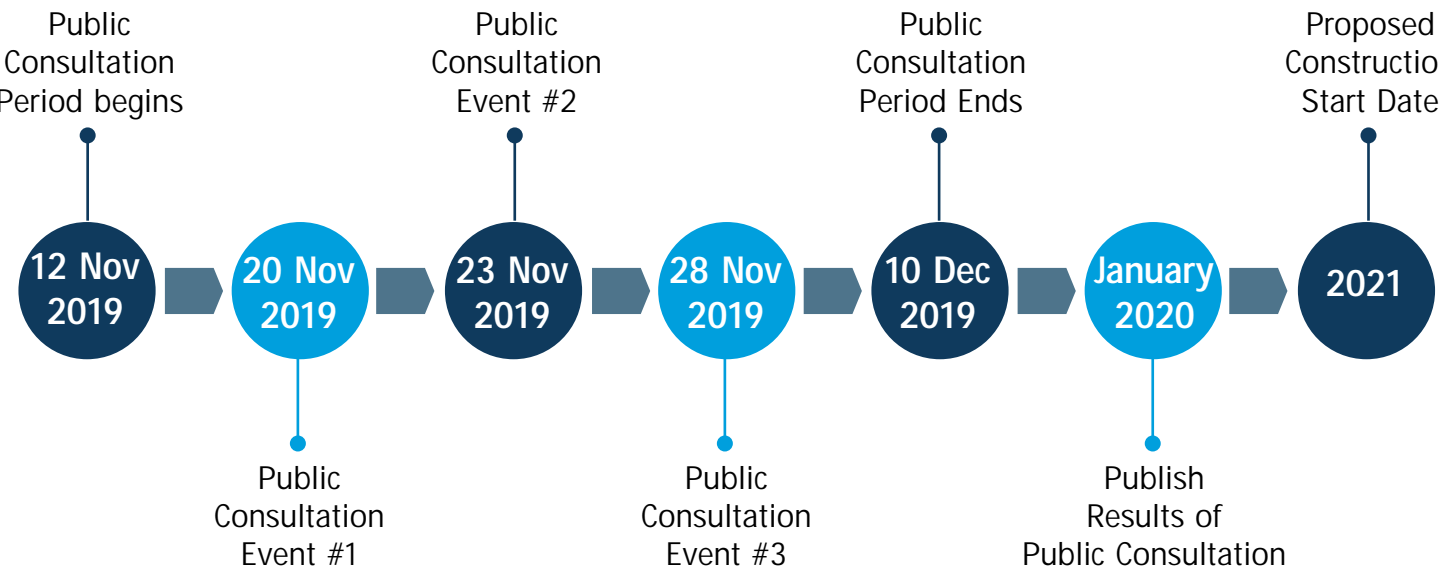



Have your say

Between 12 November and 10 December 2019 we are welcoming feedback on these proposals. You can tell us what you think by 5pm on 10 December 2019.

You can also complete the survey online at:
consultation.eastsussex.gov.uk

Completing the survey attached to this brochure and returning to:

East Sussex County Council
Communities, Economy & Transport
FREEPOST (LW43)
County Hall
Lewes
East Sussex
BN7 1BR

We will be holding three public exhibitions at the following dates and locations:

The Beacon Shopping Centre
(Next to Lush)
20 November 2019
23 November 2019
28 November 2019

We will be available between 10am and 4pm on these days.

You will be able to meet members of the project team and view the plans in detail at these exhibitions.

You can also contact us with any questions and comments:

customer@eastsussexhighways.com
Tel: 0345 60 80 193

Copies of this brochure can be found at the following locations:

Eastbourne Library, Grove Road,
BN21 4TL

Eastbourne Town Hall, Grove Road,
BN21 4TX

Eastbourne Citizens Advice Bureau,
8 St Leonard's Road, BN21 3UH

The Pantry Café, Eastbourne Age Concern,
The William and Patricia Venton Centre,
Junction Road, BN21 3QY

Old Town Community Centre,
Old Town, BN20 8PL

Old Town Library,
191 Victoria Drive, BN20 8QJ

Hampden Park Community Hall,
Brodrick Road, BN22 9NR

St Anthony's Centre,
557a Seaside, BN23 6NH

Willingdon Trees Community Centre,
Holly Place, BN22 0UT

3VA Voluntary Action Support Service,
8 Saffrons Road, BN21



Eastbourne Town Centre Movement & Access Package Phase 2 – Terminus Road (Bankers Corner to Langney Road)

Public Engagement Survey



Questionnaire

Before we continue after the completion of Phase 1 of the Eastbourne Town Centre improvements, we would like your views on our proposals for the next phase in relation to the section of Terminus Road from Bankers Corner to Langney Road.

Your feedback will help us shape our design to continue the transformation of Eastbourne Town Centre.

1. What do you do when you visit Eastbourne Town Centre? Tick all that apply.

- ☐ It is where I live
- ☐ It is where I Work
- ☐ I come here to shop
- ☐ I come here to use services (e.g. banks, doctors etc)
- ☐ I come here for leisure
- ☐ I come to do business
- ☐ Other

2. Overall, to what extent do you support our proposals for Phase 2 of the scheme, which covers Terminus Road from “Bankers’ Corner”) to Bolton Road and Langney Road?

Strongly support	Support	Neither support nor oppose	Oppose	Strongly oppose
<input type="checkbox"/>	<input type="checkbox"/>	<input type="checkbox"/>	<input type="checkbox"/>	<input type="checkbox"/>

3. To what extent do you agree that these plans will improve this part of the Town Centre for residents, visitors and businesses? Please tick as appropriate.

	Strongly agree	Agree	Neither agree or disagree	Disagree	Strongly disagree
Residents	<input type="checkbox"/>	<input type="checkbox"/>	<input type="checkbox"/>	<input type="checkbox"/>	<input type="checkbox"/>
Visitors	<input type="checkbox"/>	<input type="checkbox"/>	<input type="checkbox"/>	<input type="checkbox"/>	<input type="checkbox"/>
Businesses	<input type="checkbox"/>	<input type="checkbox"/>	<input type="checkbox"/>	<input type="checkbox"/>	<input type="checkbox"/>



4. Do you agree these plans will help achieve our objectives?

	Strongly agree	Agree	Neither agree or disagree	Disagree	Strongly disagree
Improve pedestrian safety and accessibility (ease of movement for disabled people and/or older people, families with pushchairs etc.)	<input type="checkbox"/>	<input type="checkbox"/>	<input type="checkbox"/>	<input type="checkbox"/>	<input type="checkbox"/>
Help the Town Centre retail environment to thrive	<input type="checkbox"/>	<input type="checkbox"/>	<input type="checkbox"/>	<input type="checkbox"/>	<input type="checkbox"/>
Improve the appearance of the Town Centre	<input type="checkbox"/>	<input type="checkbox"/>	<input type="checkbox"/>	<input type="checkbox"/>	<input type="checkbox"/>
Promote health and sustainable travel	<input type="checkbox"/>	<input type="checkbox"/>	<input type="checkbox"/>	<input type="checkbox"/>	<input type="checkbox"/>

5. Do you agree the following changes will help achieve our objectives?

	Strongly agree	Agree	Neither agree or disagree	Disagree	Strongly disagree
Deliver improvements which support and compliment changes made in Phase 1	<input type="checkbox"/>	<input type="checkbox"/>	<input type="checkbox"/>	<input type="checkbox"/>	<input type="checkbox"/>
Improve pedestrian safety and accessibility (ease of movement for disabled people and/or older people, families with pushchairs etc.) by reallocating road space to pedestrians	<input type="checkbox"/>	<input type="checkbox"/>	<input type="checkbox"/>	<input type="checkbox"/>	<input type="checkbox"/>
Use Terminus Road to create a ‘spine route’ through the primary retail area of Eastbourne Town Centre	<input type="checkbox"/>	<input type="checkbox"/>	<input type="checkbox"/>	<input type="checkbox"/>	<input type="checkbox"/>
Coordinate the design of street furniture and signage which will be finished to a high standard in the Town Centre	<input type="checkbox"/>	<input type="checkbox"/>	<input type="checkbox"/>	<input type="checkbox"/>	<input type="checkbox"/>
Improve public realm within the Town Centre	<input type="checkbox"/>	<input type="checkbox"/>	<input type="checkbox"/>	<input type="checkbox"/>	<input type="checkbox"/>



6. The proposals include the possibility of a new civic space in the area of Terminus Road between Bolton Road (near the entrance to The Beacon) and Langney Road (near Blacks). What type of things would you like to see here? Please tick as appropriate.

	Strongly agree	Agree	Neither agree or disagree	Disagree	Strongly disagree
Public performance/event space	<input type="checkbox"/>	<input type="checkbox"/>	<input type="checkbox"/>	<input type="checkbox"/>	<input type="checkbox"/>
Public Art	<input type="checkbox"/>	<input type="checkbox"/>	<input type="checkbox"/>	<input type="checkbox"/>	<input type="checkbox"/>
Pop-up shops/ street food	<input type="checkbox"/>	<input type="checkbox"/>	<input type="checkbox"/>	<input type="checkbox"/>	<input type="checkbox"/>
Children’s outdoor play facilities	<input type="checkbox"/>	<input type="checkbox"/>	<input type="checkbox"/>	<input type="checkbox"/>	<input type="checkbox"/>

7. Do you have any comments on our proposals and the plans to improve the Town Centre?

Comments:

.....

.....

.....

.....

.....

.....

.....

.....

.....

